

VA108

Project Name:

Catalog Number:

Type

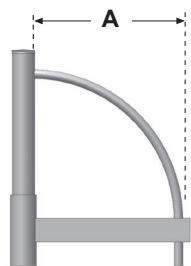

S1

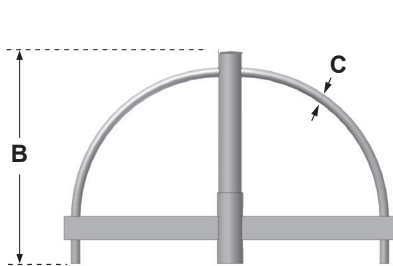

D2



WM

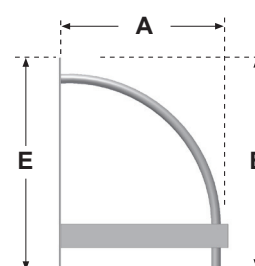

VA108 is constructed of 2" x 4" (small) or 3" x 5" (large) rectangular extruded aluminum tubing and 1 5/8" O.D. curved tubing. The center slip fitter can be made to slip over the following tenon (or pole) sizes: 3"Ø, 3 1/2"Ø, 4"Ø and 4 1/2"Ø. **VA108** is available in the following pole mounting configurations: Single and Double 180°. Please consult factory for custom mounting.

Fixture	A	B	C	D	E	EPA S1	EPA D2	EPA WM
VA108-L	24"	36"	1 5/8" Ø	7"	36"	1.9	2.5	1.2
VA108-S	18"	30"	1 5/8" Ø	7"	30"	1.7	2.5	1.0

VA108 S1

VA108 D2

Model	Mounting	Pole or Tenon Size	Finish
VA108-L	Single (S1)	3" dia. (3)	Bronze (BZ)
VA108-S	Double (D2)	3 1/2" dia. (3 1/2)	Black (BK)
	Wall Mount (WM)	4" dia. (4)	White (WH)
		4 1/2" dia. (4 1/2)	Sandstone (SN)
			Weathered Brown (WB)
			Silver Metallic (SL)
			Verdigris (VG)
			Forest Green (FG)
			Custom Color (CC)

VA109

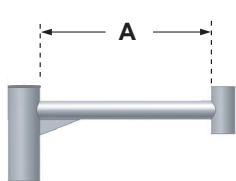

S1

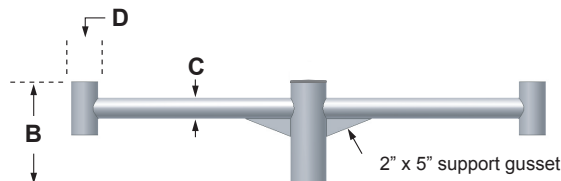

D2

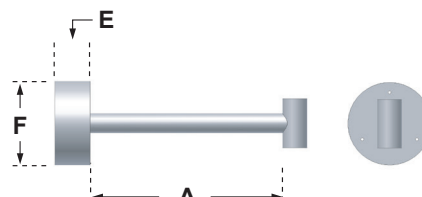

WM

*Shown with round aluminum wall plate

VA109 is available for both post top and suspended luminaires.

VA109 is constructed of 3" diameter extruded aluminum tubing. The center slip fitter can be made to slip over the following tenon (or pole) sizes: 3"Ø, 3 1/2"Ø, 4"Ø and 4 1/2"Ø. **VA109** is available in the following pole mounting configurations: Single and Double 180°. Please consult factory for custom mounting. Center section of arm will match pole design (i.e. fluted pole = fluted center arm section).

Fixture	A	B	C	D	E	F	EPA S1	EPA D2	EPA WM
VA109-L	24"	12"	2 3/8" Ø	3" Ø	4 1/4"	10 1/2"	2.5	4.1	1.6
VA109-S	18"	12"	2 3/8" Ø	3" Ø	4 1/4"	10 1/2"	2.0	3.0	1.1

VA109 S1

VA109 D2

Model	Mounting	Pole or Tenon Size	Finish
VA109-L	Single (S1)	3" dia. (3)	Bronze (BZ)
VA109-S	Double (D2)	3 1/2" dia. (3 1/2)	Black (BK)
	Wall Mount (WM)	4" dia. (4)	White (WH)
		4 1/2" dia. (4 1/2)	Sandstone (SN)
			Weathered Brown (WB)
			Silver Metallic (SL)
			Verdigris (VG)
			Forest Green (FG)
			Custom Color (CC)

For more detailed information on mounting, wiring or installation instructions, please consult factory. If poles are not ordered with fixtures, please specify mounting requirements. This document contains proprietary information of Visionaire Lighting, LLC. Any use of this information requires the written approval of Visionaire Lighting, LLC. In keeping with our TQM policy of continuous improvement, Visionaire reserves the right to change any specifications contained herein without prior notice.