

## VSX, VMX & VLX Wall Mount Installation Instruction

All installation work must be performed by a qualified, certified electrician.

**Caution!** Disconnect all power before installation.

1. Use wall mount plate template to install (4x) threaded studs (not included).

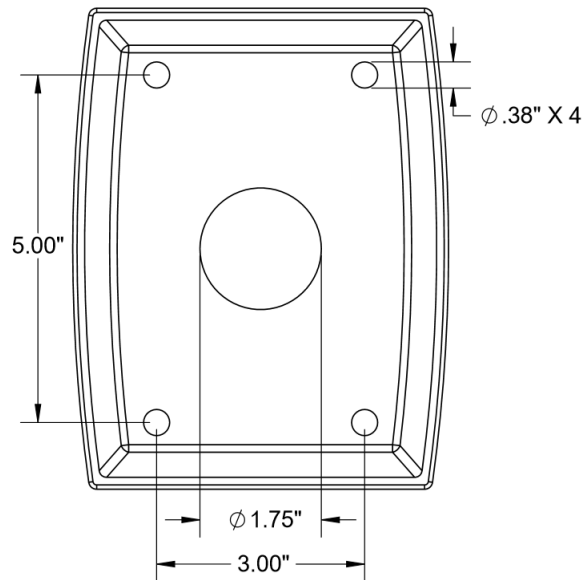

2. Attach wall mount plate to wall with (4x) hex nuts and washers (not included).

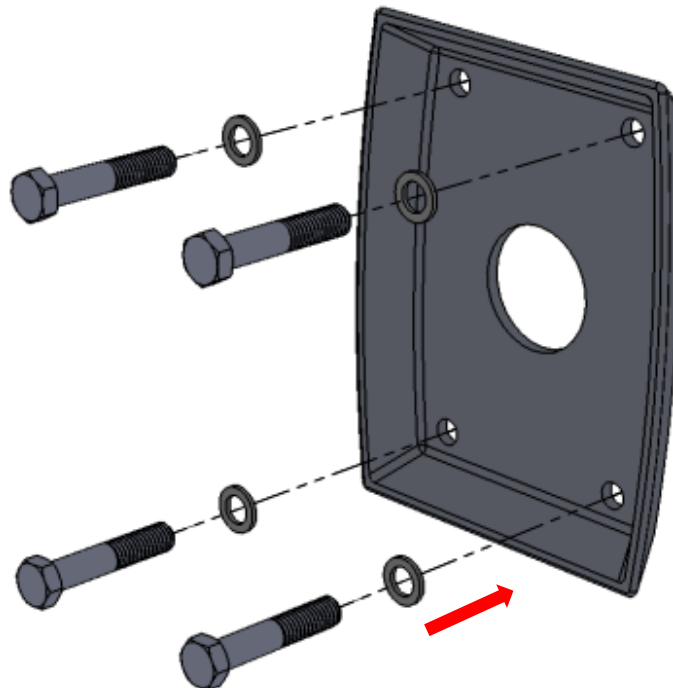

3. Align (2x) screws with castings provisions, wall mount cover, nut plate and nuts.

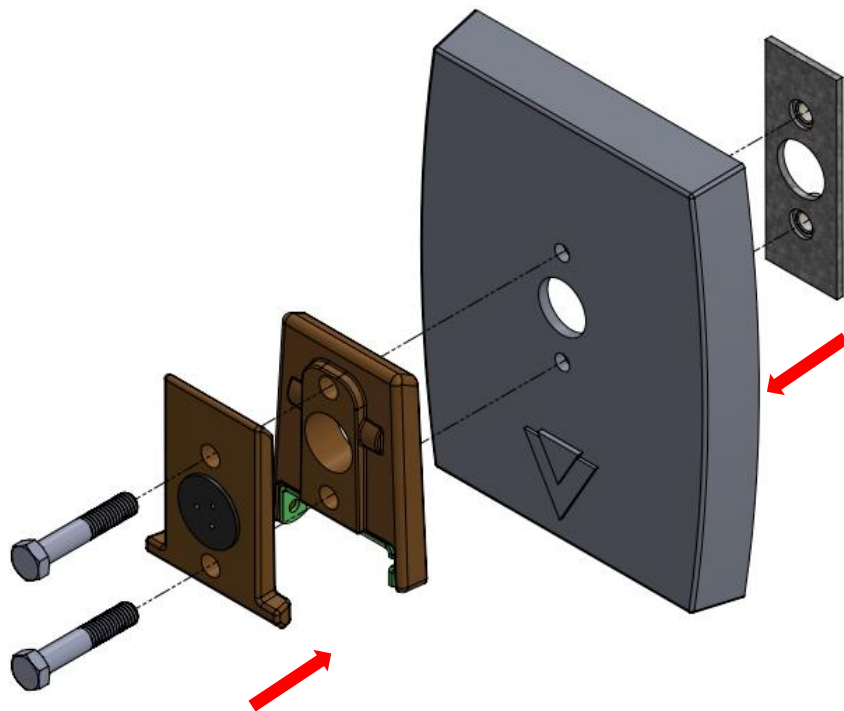

4. Fasten (2x) screws (Leave loose).

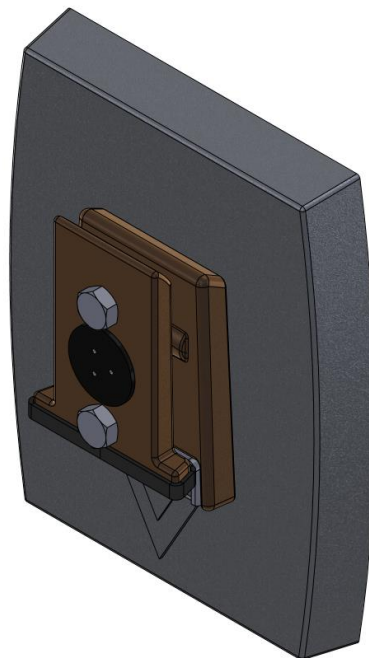

5. Place wall mount cover on wall mount plate and tighten (2x) screws at the bottom of wall mount cover.

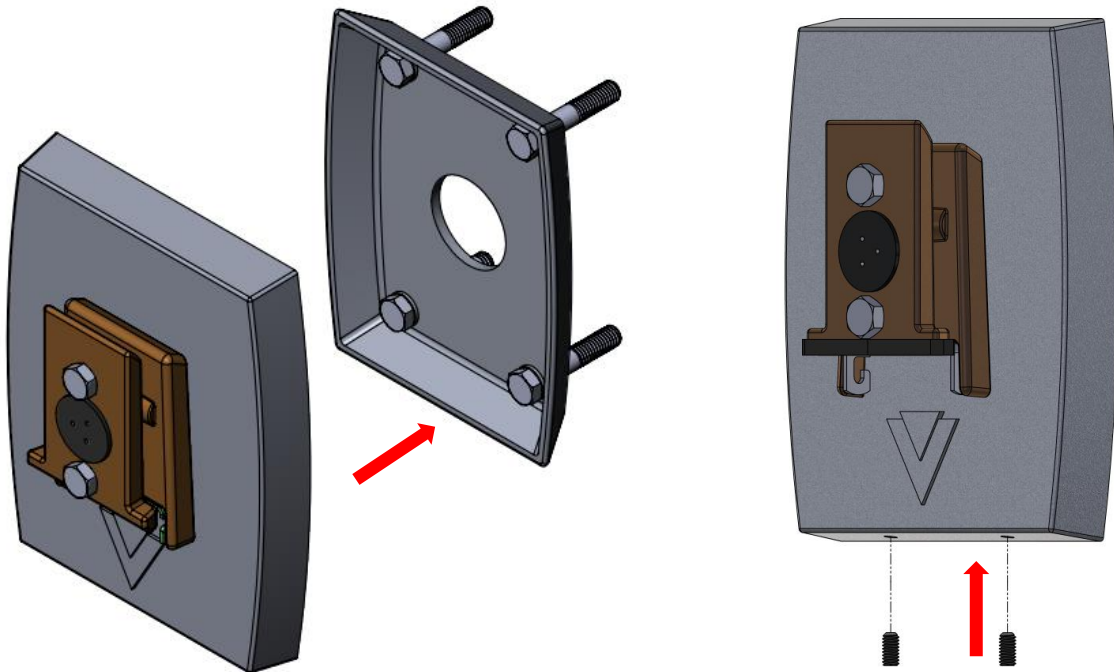

6. Slide luminaire driver compartment between the castings and fasten (2x) screws.

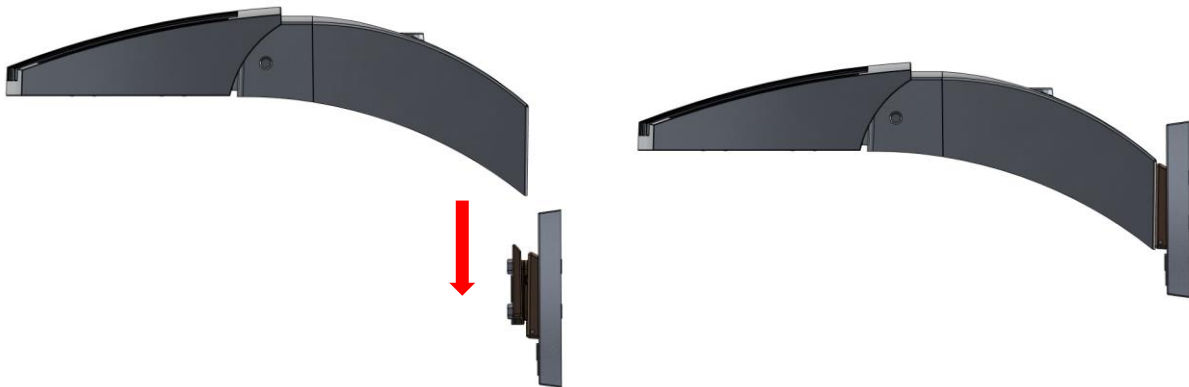

7. Assemble door to luminaire.

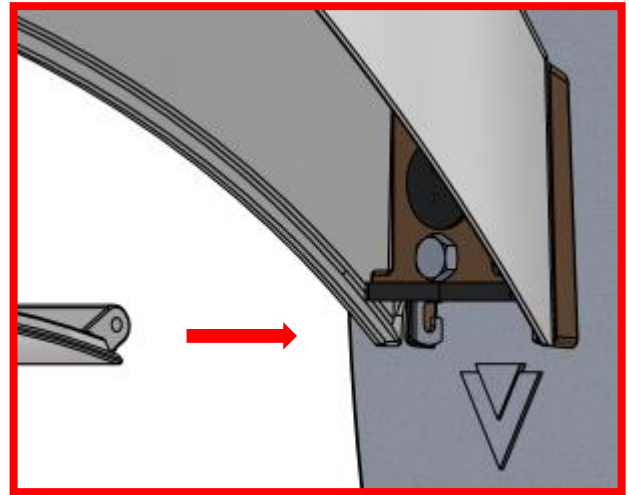
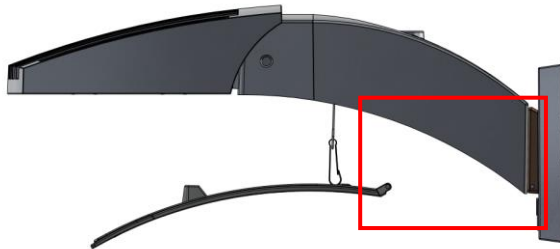

8. Attach door to the security cable assembly and push it up to close the luminaire.

