

All installation work must be performed by a qualified, certified electrician.

Caution! Disconnect all power before installation.

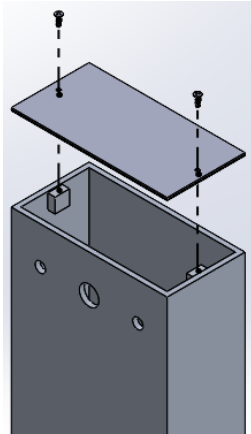

Fig. 1

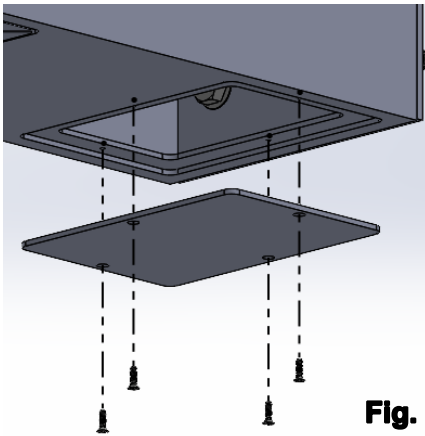

Fig. 2

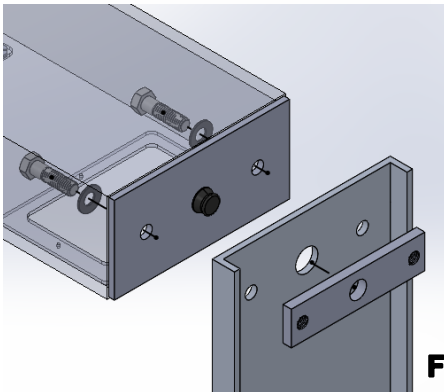

Fig. 3

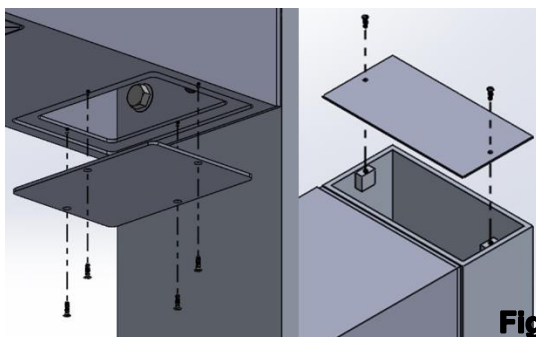

Fig. 4

BEFORE YOU BEGIN



Read these instructions completely and carefully.
Save these instructions for future use.



WARNING

To avoid possible risk of fire or shock turn off power prior to installation or maintenance preferably at circuit breaker. Product must be installed following all NEC and local Electrical Codes.

Wire lead color specifications.

(Fixture) Black → Load/Hot

(Fixture) White → Neutral/Common

(Fixture) Green → Ground

(Fixture) Purple → Dim+ (If required)

(Fixture) Grey → Dim- (If required)

UNPACKING

- This luminaire has been properly packaged so that no damage shall occur during transportation.
- Inspect and confirm.

INSTALLATION FOR TOP FIXTURE

- Remove the two pan head screws #8-32 x 1/2" and the pole cap located on top of pole. **Fig. 1**
- Remove the four flat head screws #6-32 x 1/2" and the aluminum cover located on the fixture. **Fig. 2**
- Align the fixture mount with the pole's drilling pattern and secure it with two 1/2-13 bolts with sealing washer and the nut plate. Tighten to 30 lb-ft. **Fig. 3**
- Feed wire from fixture into the pole and make the corresponding electrical connections.
- Finally place again the fixture cover and the pole cap. Tighten to 12 lbs-in. **Fig. 4**

NOTES:

Not to scale, for reference only.

Luminaire model or components can vary.



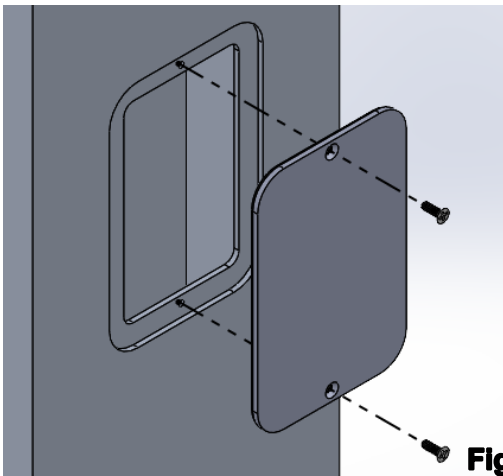

Fig. 5

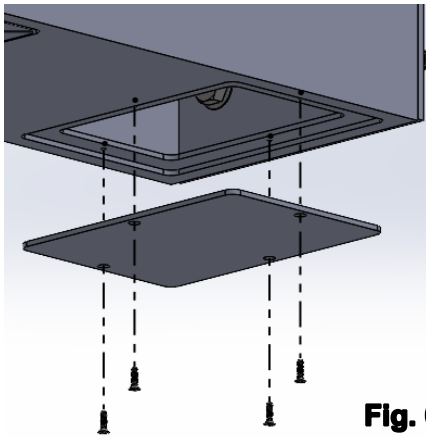

Fig. 6

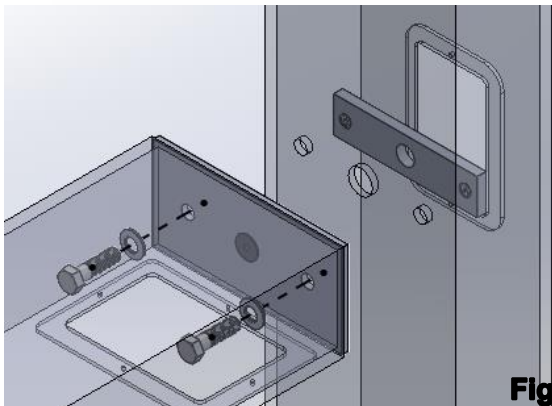

Fig. 7

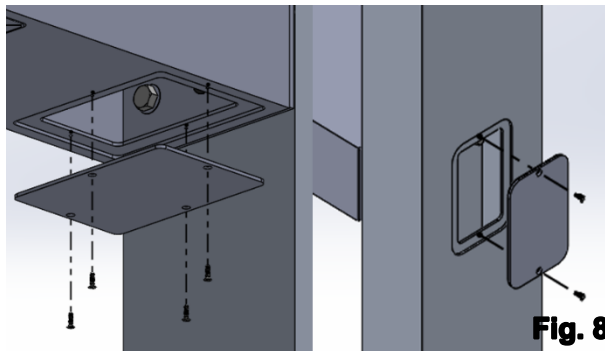

Fig. 8

INSTALLATION FOR MID FIXTURE

- Remove the two flat head screws #6-32 x 1/2" and the hand hole cover located on mid of pole. **Fig. 5**
- Remove the four flat head screws #6-32 x 1/2" and the aluminum cover located on the fixture. **Fig. 6**
- Align the fixture mount with the pole's drilling pattern and secure it with two 1/2-13 bolts with sealing washer and the nut plate. Tighten to 30 lb-ft. **Fig. 7**
- Feed wire from fixture into the pole and make the corresponding electrical connections.
- Finally place again the fixture cover and the hand hole cover. Tighten to 12 lbs-in. **Fig. 8**
- Final assembly. **Fig. 9**

NOTES:

Not to scale, for reference only.

Luminaire model or components can vary.

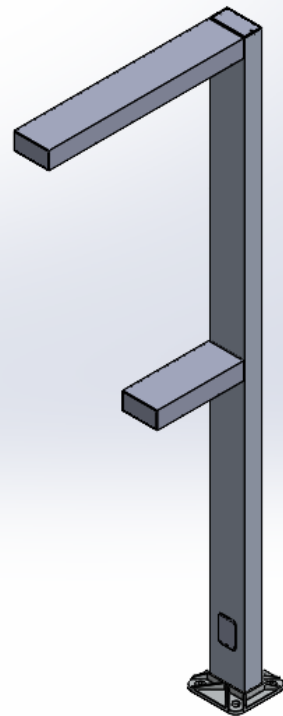

Fig. 9

