

VSX Square Pole Installation Instruction

1. Align (2x) screws and the provisions of the Castings, Pole, Nut Plate and Nuts.

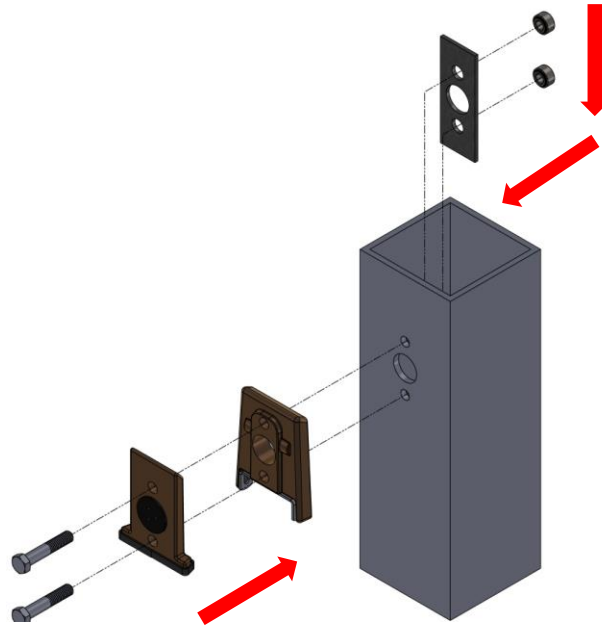

2. Fasten (2x) Screws (Leave Loose).

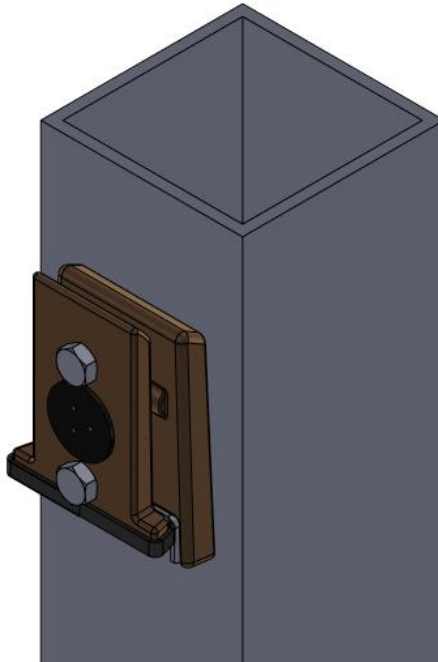

3. Slide luminaire Driver Compartment between the Castings and Fasten tightly (2x) screws.

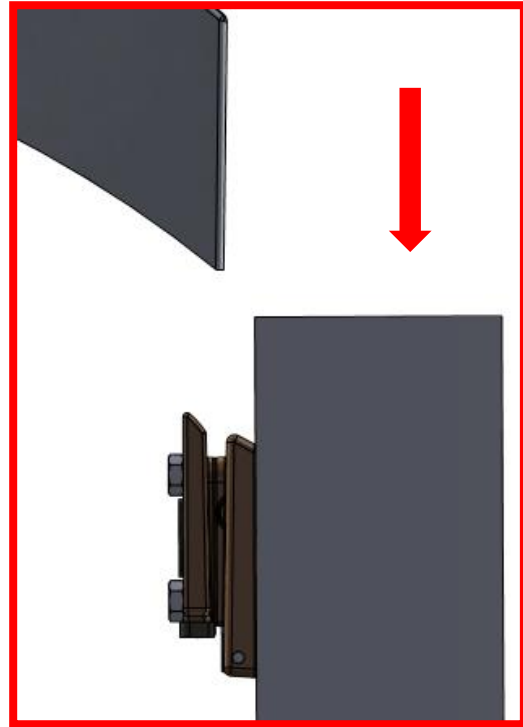
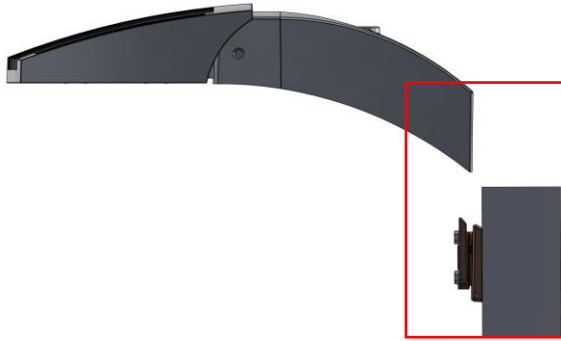

4. Assemble Door to luminaire.

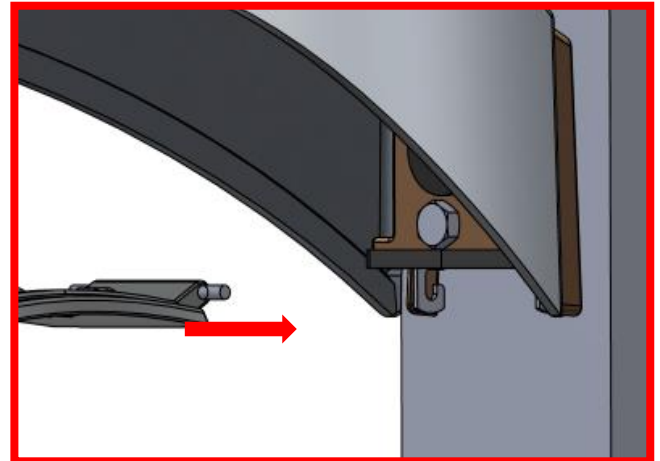
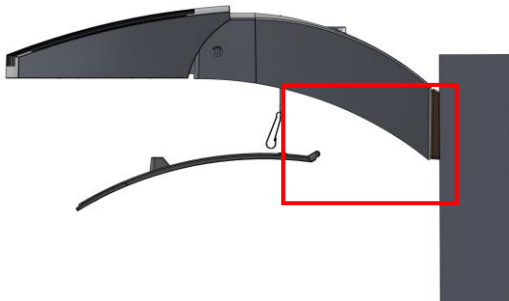

5. Attach Door to the Security cable Assembly and push it up and turn the tumb screw to close the luminaire.

