

VOKEY ARCHLINE - LED Specifications

Architectural - Commercial - Outdoor

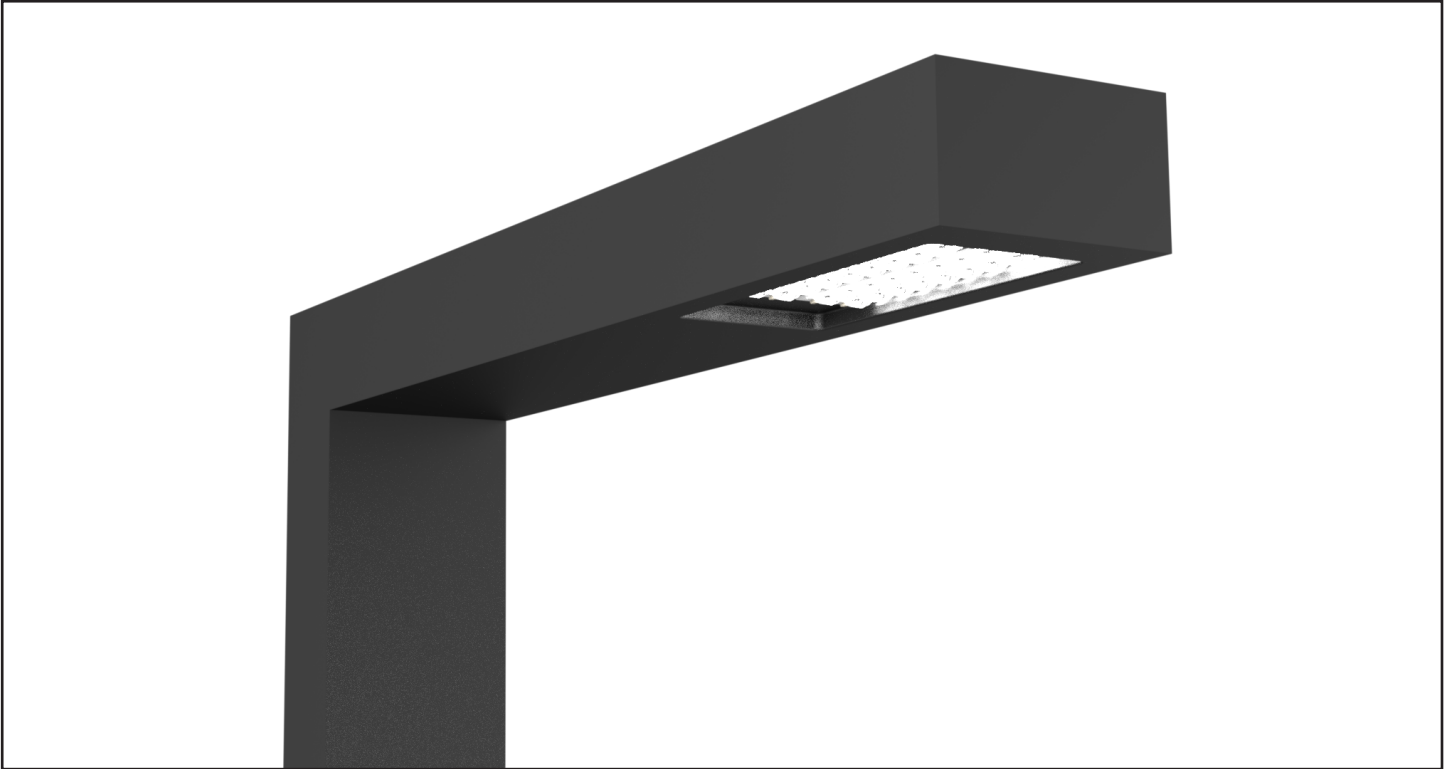

The Vokey Archline Series translates the bold, contemporary character of the Vokey family into a sleek architectural linear form, delivering 2,300 to 32,000 lumens of high-performance illumination within a refined, minimalist profile. Clean lines and a strong visual presence make it an ideal solution for projects that demand both design sophistication and lighting performance.

Crafted from precision extruded aluminum, Vokey Archline is engineered for long-term reliability, with a design that optimizes thermal performance to support LED and driver longevity while maximizing delivered light. With wattages ranging from 16W to 204W, it offers exceptional flexibility across a broad range of applications, from understated linear accents to powerful, high-output architectural runs.

To give designers greater control, the series offers nineteen optical distribution patterns that allow light to be shaped with precision for the needs of each space. Color temperatures of 2700K, 3000K, 3500K, 4000K, and 5000K are available, along with 70, 80, or 90 CRI options, making it easy to achieve the desired balance of warmth, clarity, and visual impact.

A durable polyester powder-coat finish, backed by a five-year guarantee, is offered in standard and custom colors for seamless integration with virtually any architectural palette. From modern façades and walkways to feature walls and striking architectural highlights, the Vokey Archline Series is a versatile linear lighting solution designed to look exceptional, perform beautifully, and endure.

Project Name:

Catalog Number:

Type:

Date:

Location:

Visionaire Lighting products are engineered with field serviceability and environmental responsibility at the core, giving customers a smarter, longer-lasting lighting solution. Designed for efficient maintenance and simplified access to key components, our fixtures help reduce downtime, extend product life, and make in-field updates or repairs faster and more cost-effective.



LED Specifications **VOKEY ARCHLINE**

MODEL	OPTICS		LEDs	CURRENT	CCT
VKA-1 20"	T1 Type 1	T5 Type 5	16LD 32LD	3 350mA	27K7 27K8 27K9 2700K 70, 80, & 90 CRI
VKA-2 35"	T2 Type 2	T5L Type 5 Long		5 530mA	30K7 30K8 30K9 3000K 70, 80, & 90 CRI
	T3R Type 3 Round	T5W Type 5 Wide	16LD 32LD 64LD	7 700mA	35K7 35K8 35K9 3500K 70, 80, & 90 CRI
VKA-3 45"	T3 Type 3	T5WW Type 5 Extra Wide			40K7 40K8 40K9 4000K 70, 80, & 90 CRI
	T3W Type 3 Wide	T5LG Type 5 Low Glare	64LD 96LD		50K7 50K8 50K9 5000K 70, 80, & 90 CRI
	T3LG Type 3 Low Glare	FN Flood Narrow			
	T4 Type 4	FM Flood Medium			
	T4A Type 4	FW Flood Wide			
	T4FT Type 4 Automotive				
	T4LG Type 4 Forward Throw				
	T4T Type 4 Low Glare				
	T4T Type 4 Tennis				

VOLTAGE	CONFIGURATION	FINISH	CONTROL OPTIONS	SHIELD OPTIONS	OPTIONS
UNV 120-277V	SNG Single	BZ Bronze	PCR-120 PCR-208 PCR-240 PCR-277 PCR-347 PCR-480 Photocell & Receptacle	RCLS Rightside cutoff shield	BAWP Cast Wall Plate
8 347V	D180 Double	BK Black	7PINPER 7 Pin Photo Receptacle w/shorting cap	LCLS Leftside cutoff shield	ROT-R Rotated Optics Right Side
5 480V	TRP Triple	SBK Smooth Black	Requires Dimming Driver	BHS House shield	ROT-L Rotated Optics Left Side
	QUAD Quad 180	WH White	DIM 0-10v Dimming Driver		GFI GFI Receptacle *Standard location is in hand hole. *Specify GFI location if different from hand hole location. Supplied with in use cover.
	MP Mid Pole Fixture	SWH Smooth White	DTO Dim To Off		USB USB Receptacle *Specify location. Supplied with in use cover.
	WM Wall Mount	GP Graphite	D4i D4i DALI Driver		BBG Bird Spikes
	POLE HEIGHT	GY Grey	WSP6-L2 WSP6-L3 WSP6-L7 8' Mounting Height 9-20' Mounting Height 21-40' Mounting Height		BAA Buy America(n) Act Compliant
	10	SL Silver Metallic	WSC-8 WSC-20 WSC-40 8' Mounting Height 9-20' Mounting Height 21-40' Mounting Height		BABA Build America Buy American
	12	ZFP Zinc-Free	*The WSC option will require (1) FSIR 100 remote for programming		MP FIXTURE HEIGHT
	14	CC Custom Color	TL7 7-PIN Twist -lock Wireless Control		
	16		Z10 or Z18 Zhaga 4 Pin Receptacle		10
	18		VWC Visionaire Wireless Control		12
	20				14
	22				16
	24				18
					20

Housing

The 4" x 8" extruded pole contains the driver(s), allowing for cooler operation and longer life. Silicone gasketing is utilized throughout the fixture for weather tight operation.

Heatsink

A precision-engineered aluminum heatsink designed to optimize thermal management, improve system efficiency, and support long-term LED performance and reliability.

Construction

Extruded aluminum driver compartment utilizes stainless steel hardware and sealed with one-piece silicone gaskets.

Thermal Management

The VKA series provides excellent thermal management by mounting the LEDs to the substantial heat sink. This enables the Luminaire to withstand higher ambient temperatures and driver currents without degrading LED life.

The L70 test determines the point in an LEDs life when it reaches 70 percent of its initial output. The VKA series LEDs have been determined to last 100,000+ hours in 25° C environments when driven at 350 mA.

Optical System

Available with 19 precision IES distribution patterns.

- LED engines available in multiples of 16 LEDs.
- CRI Options: 70, 80, or 90.
- CCT Options: 2700K, 3000K, 3500K, 4000K, 5000K.

Quali-Guard® Finish

The finish is a Quali-Guard® textured, chemically pretreated through a multiple-stage washer, electrostatically applied, thermoset polyester powder coat finish, with a minimum of 3-5 mils thickness. Finish is oven-baked at 400 °F to promote maximum adherence and finish hardness.

- All finishes are available in standard and custom colors.
- Optional Zinc-Free Primer - Recommended within three miles of the ocean
- Finish is guaranteed for five (5) years.

Electrical Assembly

The VKA Series is supplied with a choice of 350, 530, or 700mA high-performance LED drivers, that accept 120v thru 480v, 50 Hz to 60 Hz, input.

- Rated for -40 °C to +55 °C operations.
- Power factor of 90%.
- THD less than or equal to 20%
- 10 kV surge protector supplied as standard.
- 0-10v Dimming Driver supplied as standard.

Warranty

Five (5) year Limited Warranty on electrical components.
Five (5) year Limited Warranty on finish.
For full warranty information, please visit visionairelighting.com.

Options

- Wattstopper Plus
- Wattstopper FSP-211 Motion Sensor/Control
- Photocell & Receptacle
- Photo Receptacle (PER) (5/7PINPER)
- 7-Pin Twist-lock wireless control
- 0-10V Dimming Driver
- Dim To Off Driver
- D4i DALI Driver
- Back House Shield
- Cut-Off Louver Shield
- Zhaga 4 Pin Receptacle
- Bird Spikes
- BAA / BABA

Listings

- The VKA Series is cULs Pending
- IP66 Rated Housing
- ANSI
- RoHS Compliant
- Powder Coated Tough



3000K or lower must be selected with a fixed mount for IDA certification.
Fixed mount must be selected for IDA dark sky certification.

Light Color

Correlated Color Temperature (CCT)

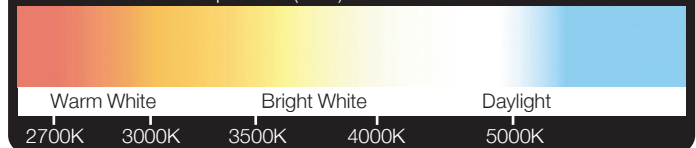

LED Specifications **VOKEY ARCHLINE**

Photometric Optical Summary

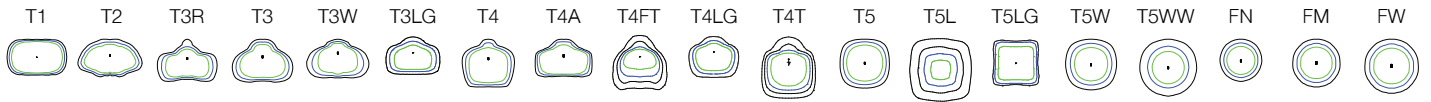

Dimensions

Width:	VKA-1 20"	Width:	VKA-2 35"	Width:	VKA-3 45"
Depth:	VKA-1 8"	Depth:	VKA-2 8"	Depth:	VKA-3 8"
Height:	VKA-1 4.0"	Height:	VKA-2 4.0"	Height:	VKA-3 4.0"
Weight:	17 LBS	Weight:	28.5 LBS	Weight:	36.5 LBS

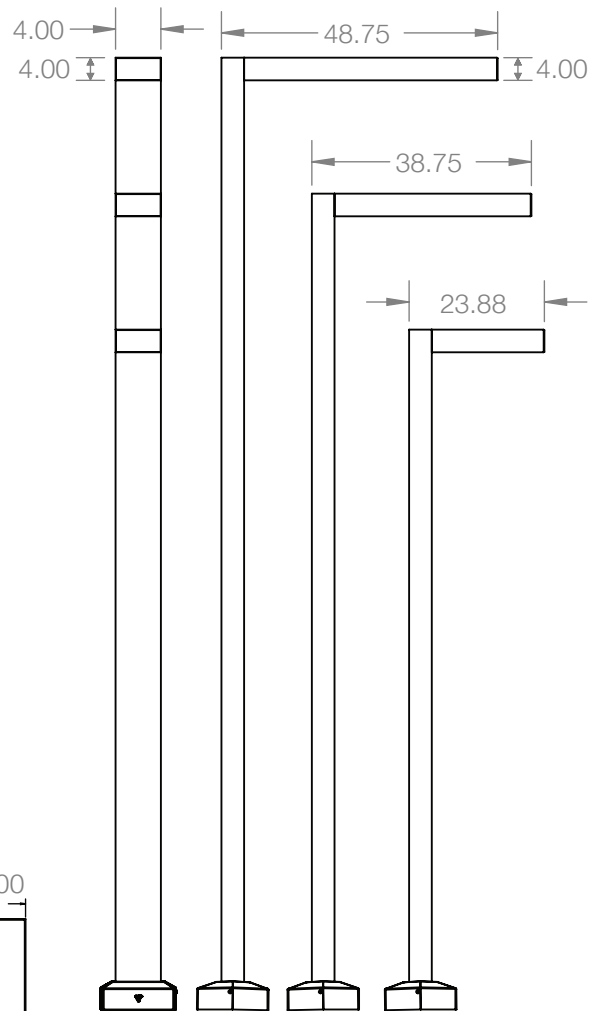
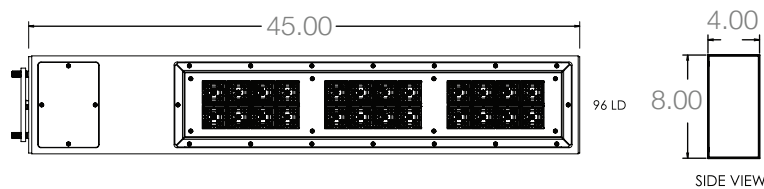
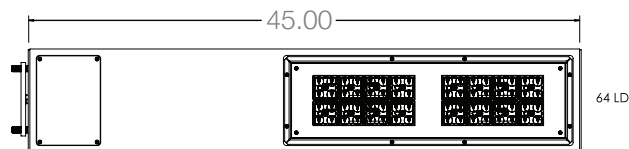
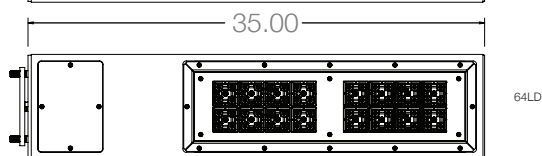
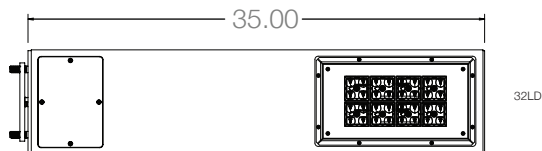
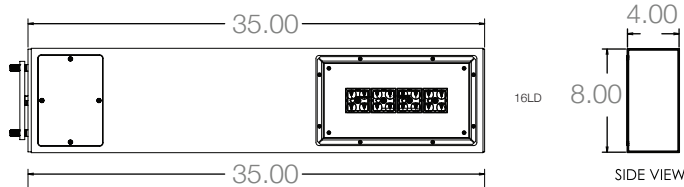
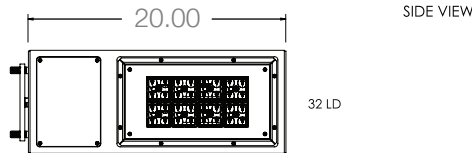
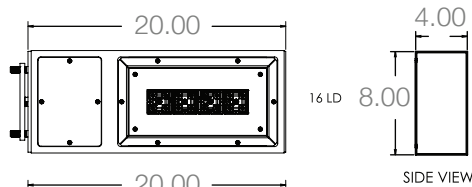

**VOKEY ARCHLINE
CONFIGURATION GUIDE & EPA DATA**



SNG

Single fixture config.



D180

Double fixture config.

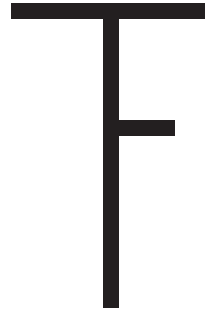

TRP

Three fixture config.
with 2 fixtures D180
and a Mid-Pole Fixture

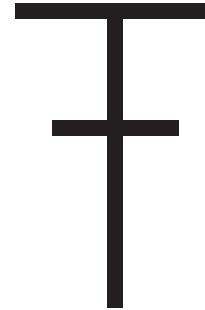

QUAD

Four fixture config.
with 2 fixtures D180
and 2 Mid-Pole Fixtures
D180

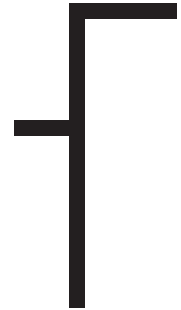

MP

Two fixture config.
with 1 fixture at the top
and a Mid-Pole Fixture

SINGLE		
SIZE	AREA	EPA
VKA-1	.5552	.6663
VKA-2	.9719	1.1663
VKA-3	1.2497	1.4996

D180		
SIZE	AREA	EPA
(2) VKA-1	1.1105	1.3326
(2) VKA-2	1.9438	2.3326
(2) VKA-3	2.4993	2.9992

TRP		
SIZE	AREA	EPA
(3) VKA-1	1.1105	1.3326
(2) VKA-2 + (1) VKA-1	1.9438	2.3326
(2) VKA-3 + (1) VKA-1	2.4993	2.9992
(2) VKA-3 + (1) VKA-2	3.4712	4.1655

QUAD		
SIZE	AREA	EPA
(4) VKA-1	2.2209	2.6651
(2) VKA-2 + (2) VKA-1	3.0543	3.6651
(2) VKA-3 + (2) VKA-1	3.6098	4.3318
(2) VKA-3 + (2) VKA-2	4.4431	5.3318

MP		
SIZE	AREA	EPA
VKA-1 + VKA-1	1.1105	1.3326
VKA-2 + VKA-1	1.5271	1.8326
VKA-2 + VKA-2	1.9438	2.3326
VKA-3 + VKA-1	1.8049	2.1659
VKA-3 + VKA-2	2.2216	2.6659

MP		
SIZE	AREA	EPA
VKA Pole 10'	3.5989	4.3187
VKA Pole 12'	4.2656	5.1187
VKA Pole 14'	4.9323	5.9187
VKA Pole 16'	5.5989	6.7187
VKA Pole 18'	6.2656	7.5187
VKA Pole 20'	6.9323	8.3187
VKA Pole 22'	7.5989	9.1187
VKA Pole 24'	8.2656	9.9187

- * Consult the factory for any configuration that includes a mid pole fixture.
- * All Mid-Pole Fixture configurations must include Mid-Pole Fixture height.

LED Specifications **VOKEY ARCHLINE**

VKA-1 - ELECTRICAL LOAD (A)							
Ordering Nomenclature	System Watts	120	208	240	277	347	480
VKA-1-16LD-3	16	0.13	0.08	0.07	0.06	0.05	0.03
VKA-1-16LD-5	25	0.21	0.12	0.10	0.09	0.07	0.05
VKA-1-16LD-7	34	0.28	0.16	0.14	0.12	0.10	0.07
VKA-1-32LD-3	33	0.28	0.16	0.14	0.12	0.10	0.07
VKA-1-32LD-5	51	0.43	0.25	0.21	0.18	0.15	0.11
VKA-1-32LD-7	68	0.57	0.33	0.28	0.25	0.20	0.14
ELECTRICAL LOAD DATA IS ESTIMATED							

VKA-2 - ELECTRICAL LOAD (A)							
Ordering Nomenclature	System Watts	120	208	240	277	347	480
VKA-2-16LD-3	16	0.13	0.08	0.07	0.06	0.05	0.03
VKA-2-16LD-5	25	0.21	0.12	0.10	0.09	0.07	0.05
VKA-2-16LD-7	34	0.28	0.16	0.14	0.12	0.10	0.07
VKA-2-32LD-3	33	0.28	0.16	0.14	0.12	0.10	0.07
VKA-2-32LD-5	51	0.43	0.25	0.21	0.18	0.15	0.11
VKA-2-32LD-7	68	0.57	0.33	0.28	0.25	0.20	0.14
VKA-2-64LD-3	66	0.55	0.32	0.28	0.24	0.19	0.14
VKA-2-64LD-5	101	0.84	0.49	0.42	0.36	0.29	0.21
VKA-2-64LD-7	136	1.13	0.65	0.57	0.49	0.39	0.28
ELECTRICAL LOAD DATA IS ESTIMATED							

VKA-3 - ELECTRICAL LOAD (A)							
Ordering Nomenclature	System Watts	120	208	240	277	347	480
VKA-3-64LD-3	66	0.55	0.32	0.28	0.24	0.19	0.14
VKA-3-64LD-5	101	0.84	0.49	0.42	0.36	0.29	0.21
VKA-3-64LD-7	136	1.13	0.65	0.57	0.49	0.39	0.28
VKA-3-96LD-3	99	0.83	0.48	0.41	0.36	0.29	0.21
VKA-3-96LD-5	152	1.27	0.73	0.63	0.55	0.44	0.32
VKA-3-96LD-7	204	1.70	0.98	0.85	0.74	0.59	0.43
ELECTRICAL LOAD DATA IS ESTIMATED							

CAST BASE COVER

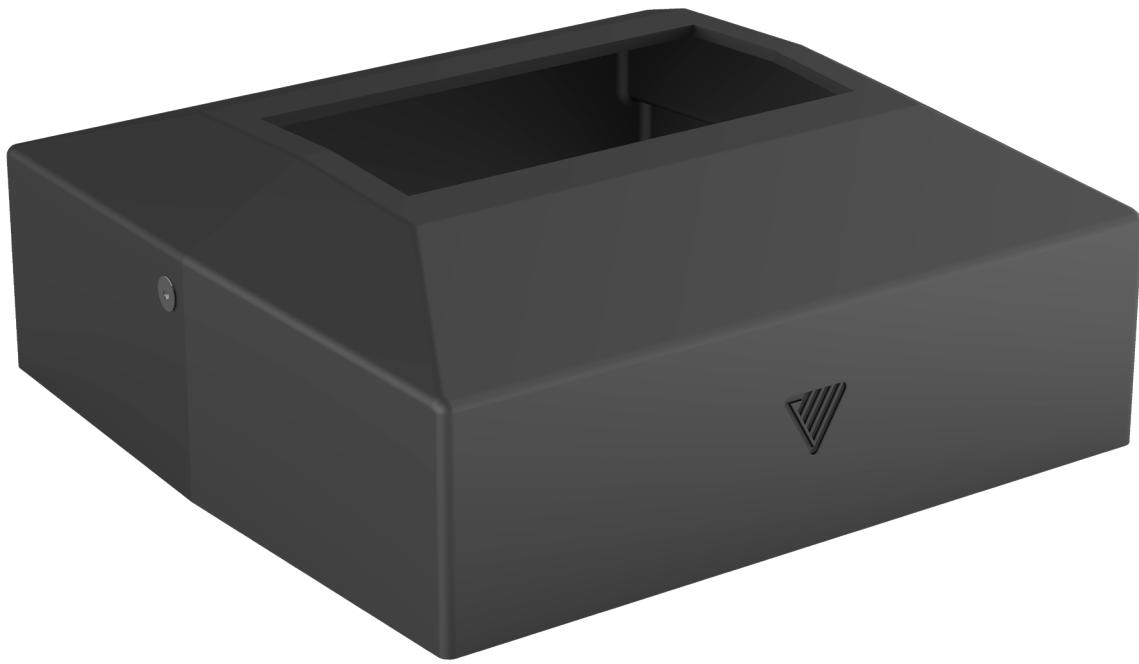
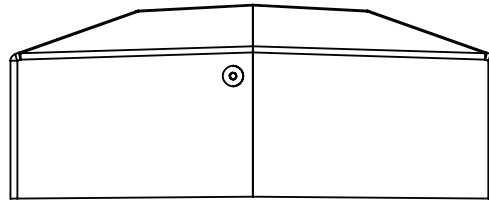
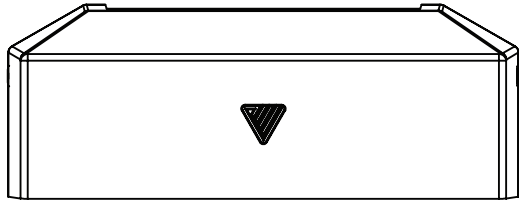

Description: TEMPLATE CAST BASE PLATE FOR VKA (4" X 8") ALUMINUM POLE BASE

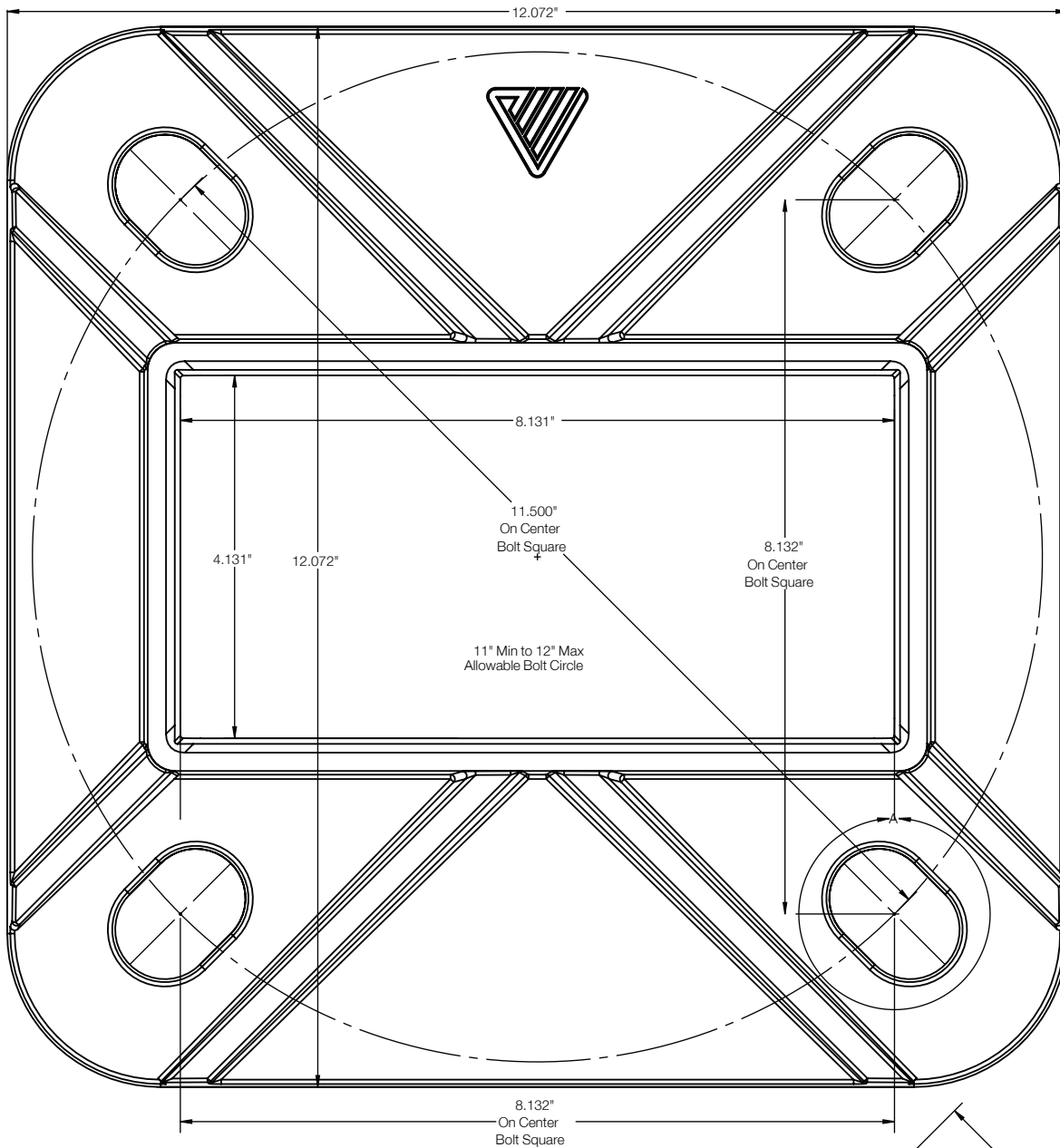

NOTES: UNLESS OTHERWISE SPECIFIED.
 1. ALL DIMENSIONS ARE IN INCHES.
 2. UNLESS OTHERWISE SPECIFIED, ALL HOLES ARE THRU

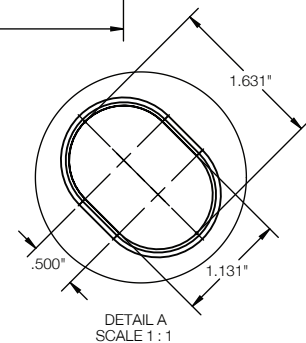
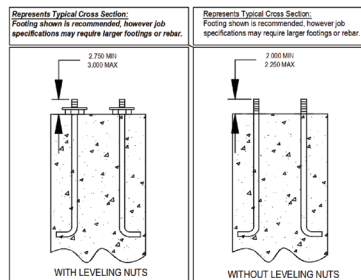

NOT TO SCALE

WATTSTOPPER PLUS

FSP-600 Series

The FSP-600 series by Wattstopper PLUS is an integrated luminaire level lighting controller and sensor for indoor/outdoor lighting applications that require networked wireless control. The FSP-600 is designed to integrate directly into exterior, high bay, parking garage, and general site lighting solutions. It is a passive infrared (PIR) sensor and closed loop photosensor.

The FSP-600 series design intends to reduce installer labor time and make on-site start up easy for technicians.

Once commissioned and paired to a Wattstopper PLUS network, the devices can measure both motion and daylight contribution in order to automatically switch or dim lighting. It also provides the ability to communicate to other fixtures in the space without any front-end devices.

The Wattstopper PLUS FSP-600 series is available in a few different options including: internal, external straight nipple, and external drop nipple. Sensor lens options sold separately and should be ordered based on designed mounting height and desired finish.

FSP-621



FSP-200 Series

The FSP-200 series sensors provide multi-level control based on motion and/or daylight contribution. They control 0-10 VDC LED drivers or dimming ballasts, as well as non-dimming ballasts and, with an FSP-Lx Lens, are rated for wet and cold locations. All control parameters are adjustable via a wireless configuration tool capable of storing and transmitting sensor profiles. The FSP-200 series is available in two different voltage configurations adding flexibility to your fixture design or project.

Typically, the sensor ramps lighting On to the selected High mode level when motion is detected and the ambient light level is below the hold off setpoint. After the sensor stops detecting movement and the time delay elapses, lights fade to the Low mode level. If there is no motion during the subsequent cut off time delay, the lights will turn Off. For dusk to dawn control, the integral photocell can switch the lights On and Off based on the ambient light level so that lighting remains on overnight even without motion detection.

Initial setup and subsequent sensor adjustments are made using a Wireless Handheld Configuration Tool (FSIR-100). This tool enables adjustment of parameters including high and low modes, sensitivity, time delay, cut off and more. The FSIR-100 is also used to initiate automatic calibration of the FSP-2x1B ambient light level setpoint. The setpoint is used to hold the controlled lighting off or at a low level when there is sufficient daylight. The wireless tool stores up to six sensor parameter profiles to speed configuration of multiple sensors.

FSP-211

FSP-221



Motion Sensor Default Settings								
High Mode	Low Mode	Time Delay	Cut Off	Sensitivity	Hold Off Set-point	Photocell	Ramp Up Time	Fade Down Time
10V	1V	5 Minutes	1 Hour	Maximum	4ft	Disabled	Disabled	Disabled

*Settings can be field modified with the FSIR-100 Programming remote

Lens with Shroud Dimensions

The FSP-Lx-S models include a shroud, which blocks high-angle light coming from the fixture, to improve photocell performance. With the shroud attached, the dimensions for all three lenses are identical

FSP-L2-S and FSP-L3-S

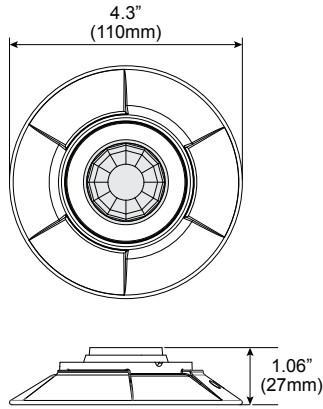

FSP-L7-S

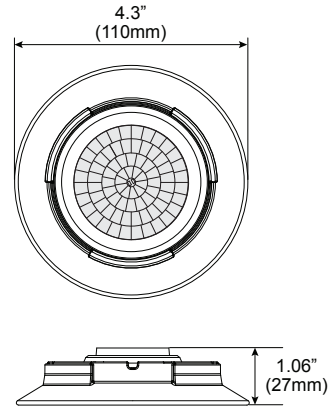

COVERAGE

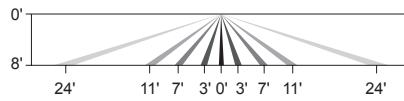
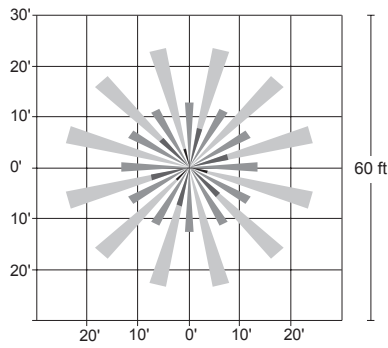

FSP-L2 top and side coverage patterns

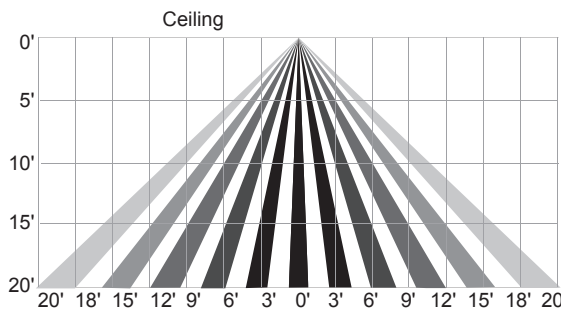
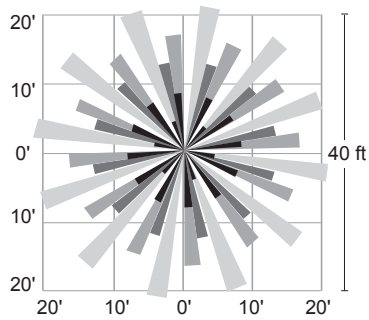

FSP-L3 top and side coverage patterns

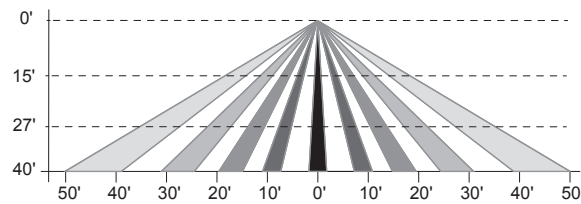
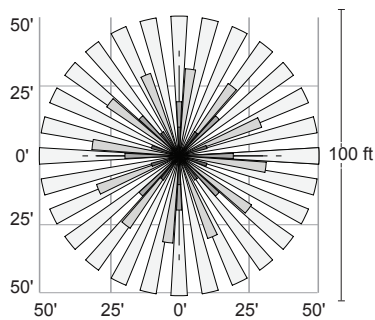

FSP-L7 top and side coverage patterns

LED Specifications VOKEY ARCHLINE

		VKA-1 LED SPECIFICATIONS / Forward Optics																									
Led Count	Current & Watts	Distribution Type	70CRI																								
			27K					30K					35K					40K					50K				
			Lumens	B	U	G	LPW	Lumens	B	U	G	LPW	Lumens	B	U	G	LPW	Lumens	B	U	G	LPW	Lumens	B	U	G	LPW
16LD	350 mA (16.4W)	T1	2516	2	0	2	153	2625	2	0	2	160	2625	2	0	2	160	2598	2	0	2	158	2734	2	0	2	166
		T2	2524	1	0	1	154	2634	1	0	1	160	2634	1	0	1	160	2606	1	0	1	159	2743	1	0	1	167
		T3R	2492	1	0	1	152	2601	1	0	1	158	2601	1	0	1	158	2574	1	0	1	157	2709	1	0	1	165
		T3	2527	1	0	1	154	2637	1	0	1	160	2637	1	0	1	160	2609	1	0	1	159	2747	1	0	1	167
		T3W	2580	1	0	1	157	2692	1	0	1	164	2692	1	0	1	164	2664	1	0	1	162	2804	1	0	1	171
		T3LG	2600	1	0	1	158	2713	1	0	1	165	2713	1	0	1	165	2684	1	0	1	163	2826	1	0	1	172
		T4	2523	1	0	1	154	2633	1	0	1	160	2633	1	0	1	160	2606	1	0	1	159	2743	1	0	1	167
		T4A	2671	1	0	1	163	2787	1	0	1	170	2787	1	0	1	170	2758	1	0	1	168	2904	1	0	1	177
		T4FT	2417	1	0	1	147	2522	1	0	1	153	2522	1	0	1	153	2495	1	0	1	152	2627	1	0	1	160
		T4LG	2594	1	0	1	158	2707	1	0	1	165	2707	1	0	1	165	2679	1	0	1	163	2820	1	0	1	172
		T4T	2458	1	0	1	150	2565	1	0	1	156	2565	1	0	1	156	2538	1	0	1	154	2672	1	0	1	163
		T5	2646	1	0	1	161	2761	1	0	1	168	2761	1	0	1	168	2733	1	0	1	166	2876	2	0	1	175
		T5L	2454	2	0	1	149	2561	2	0	1	156	2561	2	0	1	156	2534	2	0	1	154	2668	2	0	1	162
		T5LG	2609	1	0	1	159	2723	1	0	1	166	2723	1	0	1	166	2694	1	0	1	164	2836	2	0	1	173
		T5W	2581	2	0	1	157	2693	2	0	1	164	2693	2	0	1	164	2665	2	0	1	162	2805	2	0	1	171
		T5WW	2487	2	0	2	151	2595	2	0	2	158	2595	2	0	2	158	2568	2	0	2	156	2703	2	0	2	164
		FN	2638	2	0	0	161	2753	2	0	0	168	2753	2	0	0	168	2724	2	0	0	166	2868	2	0	0	175
		FM	2649	2	0	0	161	2765	2	0	0	168	2765	2	0	0	168	2736	2	0	0	166	2880	2	0	0	175
		FW	2728	1	0	0	166	2847	1	0	0	173	2847	1	0	0	173	2817	1	0	0	171	2966	1	0	0	180
		16LD	530 mA (25.3W)	T1	3725	2	0	2	147	3887	2	0	2	153	3887	2	0	2	153	3847	2	0	2	152	4049	2	0
T2	3738			1	0	1	147	3900	1	0	2	154	3900	1	0	2	154	3860	1	0	2	152	4063	1	0	2	160
T3R	3691			1	0	1	146	3852	1	0	1	152	3852	1	0	1	152	3812	1	0	1	150	4012	1	0	1	158
T3	3742			1	0	1	148	3905	1	0	1	154	3905	1	0	1	154	3864	1	0	1	152	4068	1	0	1	160
T3W	3821			1	0	1	151	3987	1	0	1	157	3987	1	0	1	157	3945	1	0	1	156	4153	1	0	1	164
T3LG	3850			1	0	1	152	4017	1	0	1	159	4017	1	0	1	159	3975	1	0	1	157	4184	1	0	1	165
T4	3737			1	0	1	147	3899	1	0	1	154	3899	1	0	1	154	3859	1	0	1	152	4062	1	0	1	160
T4A	3956			1	0	1	156	4128	1	0	1	163	4128	1	0	1	163	4085	1	0	1	161	4300	1	0	1	170
T4FT	3579			1	0	1	141	3735	1	0	1	147	3735	1	0	1	147	3696	1	0	1	146	3890	1	0	1	153
T4LG	3842			1	0	1	152	4009	1	0	1	158	4009	1	0	1	158	3967	1	0	1	157	4176	1	0	1	165
T4T	3640			1	0	1	144	3798	1	0	1	150	3798	1	0	1	150	3759	1	0	1	148	3956	1	0	1	156
T5	3919			2	0	1	155	4089	2	0	1	161	4089	2	0	1	161	4047	2	0	1	160	4260	2	0	1	168
T5L	3635			3	0	1	143	3793	3	0	1	150	3793	3	0	1	150	3753	3	0	1	148	3951	3	0	1	156
T5LG	3864			2	0	1	152	4032	2	0	1	159	4032	2	0	1	159	3990	2	0	1	157	4200	2	0	1	166
T5W	3822			2	0	1	151	3988	2	0	1	157	3988	2	0	1	157	3946	2	0	1	156	4154	2	0	1	164
T5WW	3683			2	0	2	145	3843	3	0	3	152	3843	3	0	3	152	3803	3	0	3	150	4003	3	0	3	158
FN	3907			3	0	1	154	4077	3	0	1	161	4077	3	0	1	161	4034	3	0	1	159	4247	3	0	1	168
FM	3924			3	0	1	155	4094	3	0	1	162	4094	3	0	1	162	4052	3	0	1	160	4265	3	0	1	168
FW	4040			2	0	0	159	4216	2	0	0	166	4216	2	0	0	166	4172	2	0	0	165	4392	2	0	0	173
16LD	700 mA (34W)			T1	4830	3	0	3	142	5040	3	0	3	148	5040	3	0	3	148	4987	3	0	3	147	5250	3	0
		T2	4846	1	0	2	143	5056	1	0	2	149	5056	1	0	2	149	5004	1	0	2	147	5267	1	0	2	155
		T3R	4785	1	0	1	141	4993	1	0	1	147	4993	1	0	1	147	4941	1	0	1	145	5202	1	0	1	153
		T3	4852	1	0	1	143	5063	1	0	1	149	5063	1	0	1	149	5010	1	0	1	147	5273	1	0	1	155
		T3W	4953	1	0	1	146	5169	1	0	1	152	5169	1	0	1	152	5115	1	0	1	151	5384	1	0	1	158
		T3LG	4991	1	0	1	147	5208	1	0	1	153	5208	1	0	1	153	5154	1	0	1	152	5425	1	0	1	160
		T4	4845	1	0	1	143	5055	1	0	1	149	5055	1	0	1	149	5003	1	0	1	147	5266	1	0	1	155
		T4A	5129	1	0	1	151	5352	1	0	1	158	5352	1	0	1	158	5296	1	0	1	156	5575	1	0	1	164
		T4FT	4640	1	0	2	137	4842	1	0	2	143	4842	1	0	2	143	4791	1	0	2	141	5043	1	0	2	148
		T4LG	4981	1	0	1	147	5198	1	0	1	153	5198	1	0	1	153	5144	1	0	1	151	5414	1	0	1	159
		T4T	4719	1	0	1	139	4924	1	0	1	145	4924	1	0	1	145	4873	1	0	1	143	5129	1	0	1	151
		T5	5081	2	0	1	150	5302	2	0	1	156	5302	2	0	1	156	5246	2	0	1	154	5522	2	0	1	163
		T5L	4712	3	0	2	139	4917	3	0	2	145	4917	3	0	2	145	4866	3	0	2	143	5122	3	0	2	151
		T5LG	5010	2	0	1	147	5228	2	0	1	154	5228	2	0	1	154	5173	2	0	1	152	5446	2	0	1	160
		T5W	4955	3	0	1	146	5170	3	0	1	152	5170	3	0	1	152	5116	3	0	1	151	5385	3	0	1	159
		T5WW	4774	3	0	3	141	4982	3	0	3	147	4982	3	0	3	147	4930	3	0	3	145	5189	3	0	3	153
		FN	5065	3	0	1	149	5285	3	0	1	156	5285	3	0	1	156	5230	3	0	1	154	5506	3	0	1	162

LED Specifications VOKEY ARCHLINE

		VKA-1 LED SPECIFICATIONS / Forward Optics																									
Led Count	Current & Watts	Distribution Type	70CRI																								
			27K					30K					35K					40K					50K				
			Lumens	B	U	G	LPW	Lumens	B	U	G	LPW	Lumens	B	U	G	LPW	Lumens	B	U	G	LPW	Lumens	B	U	G	LPW
32LD	350 mA (32.9W)	T1	4982	3	0	3	152	5198	3	0	3	158	5198	3	0	3	158	5144	3	0	3	157	5415	3	0	3	165
		T2	4998	1	0	2	152	5216	1	0	2	159	5216	1	0	2	159	5161	1	0	2	157	5433	1	0	2	165
		T3R	4936	1	0	1	150	5151	1	0	1	157	5151	1	0	1	157	5097	1	0	1	155	5365	1	0	1	163
		T3	5004	1	0	1	152	5222	1	0	1	159	5222	1	0	1	159	5168	1	0	1	157	5439	1	0	1	166
		T3W	5109	1	0	1	155	5331	1	0	1	162	5331	1	0	1	162	5276	1	0	1	161	5554	1	0	1	169
		T3LG	5148	1	0	1	157	5372	1	0	1	163	5372	1	0	1	163	5316	1	0	1	162	5596	1	0	1	170
		T4	4997	1	0	1	152	5214	1	0	1	159	5214	1	0	1	159	5160	1	0	1	157	5432	2	0	2	165
		T4A	5290	1	0	1	161	5520	1	0	1	168	5520	1	0	1	168	5463	1	0	1	166	5750	1	0	1	175
		T4FT	4786	1	0	2	146	4994	1	0	2	152	4994	1	0	2	152	4942	1	0	2	150	5202	1	0	2	158
		T4LG	5138	1	0	1	156	5361	1	0	1	163	5361	1	0	1	163	5305	1	0	1	161	5585	1	0	1	170
		T4T	4868	1	0	1	148	5079	1	0	1	155	5079	1	0	1	155	5026	1	0	1	153	5291	1	0	1	161
		T5	5241	2	0	1	159	5468	2	0	1	166	5468	2	0	1	166	5412	2	0	1	165	5696	3	0	1	173
		T5L	4861	3	0	2	148	5072	3	0	2	154	5072	3	0	2	154	5019	3	0	2	153	5283	3	0	2	161
		T5LG	5168	2	0	1	157	5392	2	0	1	164	5392	2	0	1	164	5336	2	0	1	162	5617	3	0	1	171
		T5W	5110	3	0	1	155	5333	3	0	1	162	5333	3	0	1	162	5277	3	0	1	161	5555	3	0	1	169
		T5WW	4925	3	0	3	150	5139	3	0	3	156	5139	3	0	3	156	5085	3	0	3	155	5353	3	0	3	163
		FN	5225	3	0	1	159	5452	3	0	1	166	5452	3	0	1	166	5395	3	0	1	164	5679	3	0	1	173
		FM	5247	3	0	1	160	5475	3	0	1	167	5475	3	0	1	167	5418	3	0	1	165	5703	3	0	1	174
		FW	5403	2	0	0	164	5638	2	0	0	172	5638	2	0	0	172	5579	2	0	0	170	5873	2	0	0	179
		32LD	530 mA (50.7W)	T1	7378	3	0	3	146	7698	3	0	3	152	7698	3	0	3	152	7618	3	0	3	150	8019	3	0
T2	7402			2	0	2	146	7724	2	0	2	152	7724	2	0	2	152	7643	2	0	2	151	8046	2	0	2	159
T3R	7310			2	0	2	144	7628	2	0	2	150	7628	2	0	2	150	7548	2	0	2	149	7946	2	0	2	157
T3	7411			1	0	2	146	7733	1	0	2	153	7733	1	0	2	153	7653	1	0	2	151	8056	1	0	2	159
T3W	7567			1	0	2	149	7896	1	0	2	156	7896	1	0	2	156	7813	1	0	2	154	8225	1	0	2	162
T3LG	7624			2	0	2	150	7955	2	0	2	157	7955	2	0	2	157	7873	2	0	2	155	8287	2	0	2	163
T4	7401			2	0	2	146	7722	2	0	2	152	7722	2	0	2	152	7642	2	0	2	151	8044	2	0	2	159
T4A	7835			2	0	1	155	8175	2	0	1	161	8175	2	0	1	161	8090	2	0	1	160	8516	2	0	1	168
T4FT	7088			1	0	2	140	7396	1	0	2	146	7396	1	0	2	146	7319	1	0	2	144	7704	1	0	2	152
T4LG	7609			2	0	2	150	7940	2	0	2	157	7940	2	0	2	157	7857	2	0	2	155	8271	2	0	2	163
T4T	7206			2	0	1	142	7522	2	0	1	148	7522	2	0	1	148	7444	2	0	1	147	7835	2	0	1	155
T5	7761			3	0	1	153	8098	3	0	1	160	8098	3	0	1	160	8014	3	0	1	158	8436	3	0	1	166
T5L	7198			3	0	2	142	7511	3	0	2	148	7511	3	0	2	148	7433	3	0	2	147	7824	3	0	2	154
T5LG	7653			3	0	1	151	7986	3	0	1	158	7986	3	0	1	158	7902	3	0	1	156	8318	3	0	1	164
T5W	7568			3	0	2	149	7897	3	0	2	156	7897	3	0	2	156	7815	3	0	2	154	8226	3	0	2	162
T5WW	7293			3	0	3	144	7610	3	0	3	150	7610	3	0	3	150	7531	3	0	3	149	7927	3	0	3	156
FN	7737			3	0	1	153	8074	4	0	1	159	8074	4	0	1	159	7990	3	0	1	158	8410	4	0	1	166
FM	7770			3	0	1	153	8108	4	0	1	160	8108	4	0	1	160	8024	3	0	1	158	8446	4	0	1	167
FW	8002			3	0	1	158	8349	3	0	1	165	8349	3	0	1	165	8263	3	0	1	163	8697	3	0	1	172
32LD	700 mA (67.9W)			T1	9565	3	0	3	141	9981	3	0	3	147	9981	3	0	3	147	9877	3	0	3	145	10396	3	0
		T2	9596	2	0	3	141	10014	2	0	3	147	10014	2	0	3	147	9909	2	0	3	146	10431	2	0	3	154
		T3R	9477	2	0	2	139	9889	2	0	2	146	9889	2	0	2	146	9786	2	0	2	144	10301	2	0	2	152
		T3	9608	2	0	2	141	10026	2	0	2	148	10026	2	0	2	148	9921	2	0	2	146	10444	2	0	2	154
		T3W	9810	2	0	2	144	10236	2	0	2	151	10236	2	0	2	151	10130	2	0	2	149	10663	2	0	2	157
		T3LG	9884	2	0	2	145	10314	2	0	2	152	10314	2	0	2	152	10206	2	0	2	150	10743	2	0	2	158
		T4	9594	2	0	2	141	10012	2	0	2	147	10012	2	0	2	147	9907	2	0	2	146	10429	2	0	2	153
		T4A	10157	2	0	1	149	10599	2	0	1	156	10599	2	0	1	156	10488	2	0	1	154	11040	2	0	1	162
		T4FT	9189	2	0	3	135	9588	2	0	3	141	9588	2	0	3	141	9488	2	0	3	140	9988	2	0	3	147
		T4LG	9865	2	0	2	145	10293	2	0	2	152	10293	2	0	2	152	10186	2	0	2	150	10722	2	0	2	158
		T4T	9345	2	0	1	138	9752	2	0	1	144	9752	2	0	1	144	9650	2	0	1	142	10158	2	0	1	150
		T5	10062	3	0	2	148	10499	3	0	2	155	10499	3	0	2	155	10390	3	0	2	153	10937	3	0	2	161
		T5L	9332	4	0	2	137	9738	4	0	2	143	9738	4	0	2	143	9636	4	0	2	142	10143	4	0	2	149
		T5LG	9922	3	0	1	146	10353	3	0	2	152	10353	3	0	2	152	10245	3	0	2	151	10784	3	0	2	159
		T5W	9812	3	0	2	144	10238	3	0	2	151	10238	3	0	2	151	10132	3	0	2	149	10665	4	0	2	157
		T5WW	9455	4	0	4	139	9866	4	0	4	145	9866	4	0	4	145	9763	4	0	4	144	10277	4	0	4	151
		FN	10031	4	0	1	148	10467	4	0	1	154	10467	4	0	1	154	10358	4	0	1</						

LED Specifications VOKEY ARCHLINE

		VKA-2 LED SPECIFICATIONS / Forward Optics																									
Led Count	Current & Watts	Distribution Type	70CRI																								
			27K					30K					35K					40K					50K				
			Lumens	B	U	G	LPW	Lumens	B	U	G	LPW	Lumens	B	U	G	LPW	Lumens	B	U	G	LPW	Lumens	B	U	G	LPW
16LD	350 mA (16.4W)	T1	2516	2	0	2	153	2625	2	0	2	160	2625	2	0	2	160	2598	2	0	2	158	2734	2	0	2	166
		T2	2524	1	0	1	154	2634	1	0	1	160	2634	1	0	1	160	2606	1	0	1	159	2743	1	0	1	167
		T3R	2492	1	0	1	152	2601	1	0	1	158	2601	1	0	1	158	2574	1	0	1	157	2709	1	0	1	165
		T3	2527	1	0	1	154	2637	1	0	1	160	2637	1	0	1	160	2609	1	0	1	159	2747	1	0	1	167
		T3W	2580	1	0	1	157	2692	1	0	1	164	2692	1	0	1	164	2664	1	0	1	162	2804	1	0	1	171
		T3LG	2600	1	0	1	158	2713	1	0	1	165	2713	1	0	1	165	2684	1	0	1	163	2826	1	0	1	172
		T4	2523	1	0	1	154	2633	1	0	1	160	2633	1	0	1	160	2606	1	0	1	159	2743	1	0	1	167
		T4A	2671	1	0	1	163	2787	1	0	1	170	2787	1	0	1	170	2758	1	0	1	168	2904	1	0	1	177
		T4FT	2417	1	0	1	147	2522	1	0	1	153	2522	1	0	1	153	2495	1	0	1	152	2627	1	0	1	160
		T4LG	2594	1	0	1	158	2707	1	0	1	165	2707	1	0	1	165	2679	1	0	1	163	2820	1	0	1	172
		T4T	2458	1	0	1	150	2565	1	0	1	156	2565	1	0	1	156	2538	1	0	1	154	2672	1	0	1	163
		T5	2646	1	0	1	161	2761	1	0	1	168	2761	1	0	1	168	2733	1	0	1	166	2876	2	0	1	175
		T5L	2454	2	0	1	149	2561	2	0	1	156	2561	2	0	1	156	2534	2	0	1	154	2668	2	0	1	162
		T5LG	2609	1	0	1	159	2723	1	0	1	166	2723	1	0	1	166	2694	1	0	1	164	2836	2	0	1	173
		T5W	2581	2	0	1	157	2693	2	0	1	164	2693	2	0	1	164	2665	2	0	1	162	2805	2	0	1	171
		T5WW	2487	2	0	2	151	2595	2	0	2	158	2595	2	0	2	158	2568	2	0	2	156	2703	2	0	2	164
		FN	2638	2	0	0	161	2753	2	0	0	168	2753	2	0	0	168	2724	2	0	0	166	2868	2	0	0	175
		FM	2649	2	0	0	161	2765	2	0	0	168	2765	2	0	0	168	2736	2	0	0	166	2880	2	0	0	175
		FW	2728	1	0	0	166	2847	1	0	0	173	2847	1	0	0	173	2817	1	0	0	171	2966	1	0	0	180
		16LD	530 mA (25.3W)	T1	3725	2	0	2	147	3887	2	0	2	153	3887	2	0	2	153	3847	2	0	2	152	4049	2	0
T2	3738			1	0	1	147	3900	1	0	2	154	3900	1	0	2	154	3860	1	0	2	152	4063	1	0	2	160
T3R	3691			1	0	1	146	3852	1	0	1	152	3852	1	0	1	152	3812	1	0	1	150	4012	1	0	1	158
T3	3742			1	0	1	148	3905	1	0	1	154	3905	1	0	1	154	3864	1	0	1	152	4068	1	0	1	160
T3W	3821			1	0	1	151	3987	1	0	1	157	3987	1	0	1	157	3945	1	0	1	156	4153	1	0	1	164
T3LG	3850			1	0	1	152	4017	1	0	1	159	4017	1	0	1	159	3975	1	0	1	157	4184	1	0	1	165
T4	3737			1	0	1	147	3899	1	0	1	154	3899	1	0	1	154	3859	1	0	1	152	4062	1	0	1	160
T4A	3956			1	0	1	156	4128	1	0	1	163	4128	1	0	1	163	4085	1	0	1	161	4300	1	0	1	170
T4FT	3579			1	0	1	141	3735	1	0	1	147	3735	1	0	1	147	3696	1	0	1	146	3890	1	0	1	153
T4LG	3842			1	0	1	152	4009	1	0	1	158	4009	1	0	1	158	3967	1	0	1	157	4176	1	0	1	165
T4T	3640			1	0	1	144	3798	1	0	1	150	3798	1	0	1	150	3759	1	0	1	148	3956	1	0	1	156
T5	3919			2	0	1	155	4089	2	0	1	161	4089	2	0	1	161	4047	2	0	1	160	4260	2	0	1	168
T5L	3635			3	0	1	143	3793	3	0	1	150	3793	3	0	1	150	3753	3	0	1	148	3951	3	0	1	156
T5LG	3864			2	0	1	152	4032	2	0	1	159	4032	2	0	1	159	3990	2	0	1	157	4200	2	0	1	166
T5W	3822			2	0	1	151	3988	2	0	1	157	3988	2	0	1	157	3946	2	0	1	156	4154	2	0	1	164
T5WW	3683			2	0	2	145	3843	3	0	3	152	3843	3	0	3	152	3803	3	0	3	150	4003	3	0	3	158
FN	3907			3	0	1	154	4077	3	0	1	161	4077	3	0	1	161	4034	3	0	1	159	4247	3	0	1	168
FM	3924			3	0	1	155	4094	3	0	1	162	4094	3	0	1	162	4052	3	0	1	160	4265	3	0	1	168
FW	4040			2	0	0	159	4216	2	0	0	166	4216	2	0	0	166	4172	2	0	0	165	4392	2	0	0	173
16LD	700 mA (34.0W)			T1	4830	3	0	3	142	5040	3	0	3	148	5040	3	0	3	148	4987	3	0	3	147	5250	3	0
		T2	4846	1	0	2	143	5056	1	0	2	149	5056	1	0	2	149	5004	1	0	2	147	5267	1	0	2	155
		T3R	4785	1	0	1	141	4993	1	0	1	147	4993	1	0	1	147	4941	1	0	1	145	5202	1	0	1	153
		T3	4852	1	0	1	143	5063	1	0	1	149	5063	1	0	1	149	5010	1	0	1	147	5273	1	0	1	155
		T3W	4953	1	0	1	146	5169	1	0	1	152	5169	1	0	1	152	5115	1	0	1	151	5384	1	0	1	158
		T3LG	4991	1	0	1	147	5208	1	0	1	153	5208	1	0	1	153	5154	1	0	1	152	5425	1	0	1	160
		T4	4845	1	0	1	143	5055	1	0	1	149	5055	1	0	1	149	5003	1	0	1	147	5266	1	0	1	155
		T4A	5129	1	0	1	151	5352	1	0	1	158	5352	1	0	1	158	5296	1	0	1	156	5575	1	0	1	164
		T4FT	4640	1	0	2	137	4842	1	0	2	143	4842	1	0	2	143	4791	1	0	2	141	5043	1	0	2	148
		T4LG	4981	1	0	1	147	5198	1	0	1	153	5198	1	0	1	153	5144	1	0	1	151	5414	1	0	1	159
		T4T	4719	1	0	1	139	4924	1	0	1	145	4924	1	0	1	145	4873	1	0	1	143	5129	1	0	1	151
		T5	5081	2	0	1	150	5302	2	0	1	156	5302	2	0	1	156	5246	2	0	1	154	5522	2	0	1	163
		T5L	4712	3	0	2	139	4917	3	0	2	145	4917	3	0	2	145	4866	3	0	2	143	5122	3	0	2	151
		T5LG	5010	2	0	1	147	5228	2	0	1	154	5228	2	0	1	154	5173	2	0	1	152	5446	2	0	1	160
		T5W	4955	3	0	1	146	5170	3	0	1	152	5170	3	0	1	152	5116	3	0	1	151	5385	3	0	1	159
		T5WW	4774	3	0	3	141	4982	3	0	3	147	4982	3	0	3	147	4930	3	0	3	145	5189	3	0	3	153
		FN	5065	3	0	1	149	5285	3	0	1	156	5285	3	0	1	156	5230	3	0	1	154	5506	3	0	1	162

LED Specifications VOKEY ARCHLINE

		VKA-2 LED SPECIFICATIONS / Forward Optics																									
Led Count	Current & Watts	Distribution Type	70CRI																								
			27K					30K					35K					40K					50K				
			Lumens	B	U	G	LPW	Lumens	B	U	G	LPW	Lumens	B	U	G	LPW	Lumens	B	U	G	LPW	Lumens	B	U	G	LPW
32LD	350 mA (32.9W)	T1	4982	3	0	3	152	5198	3	0	3	158	5198	3	0	3	158	5144	3	0	3	157	5415	3	0	3	165
		T2	4998	1	0	2	152	5216	1	0	2	159	5216	1	0	2	159	5161	1	0	2	157	5433	1	0	2	165
		T3R	4936	1	0	1	150	5151	1	0	1	157	5151	1	0	1	157	5097	1	0	1	155	5365	1	0	1	163
		T3	5004	1	0	1	152	5222	1	0	1	159	5222	1	0	1	159	5168	1	0	1	157	5439	1	0	1	166
		T3W	5109	1	0	1	155	5331	1	0	1	162	5331	1	0	1	162	5276	1	0	1	161	5554	1	0	1	169
		T3LG	5148	1	0	1	157	5372	1	0	1	163	5372	1	0	1	163	5316	1	0	1	162	5596	1	0	1	170
		T4	4997	1	0	1	152	5214	1	0	1	159	5214	1	0	1	159	5160	1	0	1	157	5432	2	0	2	165
		T4A	5290	1	0	1	161	5520	1	0	1	168	5520	1	0	1	168	5463	1	0	1	166	5750	1	0	1	175
		T4FT	4786	1	0	2	146	4994	1	0	2	152	4994	1	0	2	152	4942	1	0	2	150	5202	1	0	2	158
		T4LG	5138	1	0	1	156	5361	1	0	1	163	5361	1	0	1	163	5305	1	0	1	161	5585	1	0	1	170
		T4T	4868	1	0	1	148	5079	1	0	1	155	5079	1	0	1	155	5026	1	0	1	153	5291	1	0	1	161
		T5	5241	2	0	1	159	5468	2	0	1	166	5468	2	0	1	166	5412	2	0	1	165	5696	3	0	1	173
		T5L	4861	3	0	2	148	5072	3	0	2	154	5072	3	0	2	154	5019	3	0	2	153	5283	3	0	2	161
		T5LG	5168	2	0	1	157	5392	2	0	1	164	5392	2	0	1	164	5336	2	0	1	162	5617	3	0	1	171
		T5W	5110	3	0	1	155	5333	3	0	1	162	5333	3	0	1	162	5277	3	0	1	161	5555	3	0	1	169
		T5WW	4925	3	0	3	150	5139	3	0	3	156	5139	3	0	3	156	5085	3	0	3	155	5353	3	0	3	163
		FN	5225	3	0	1	159	5452	3	0	1	166	5452	3	0	1	166	5395	3	0	1	164	5679	3	0	1	173
		FM	5247	3	0	1	160	5475	3	0	1	167	5475	3	0	1	167	5418	3	0	1	165	5703	3	0	1	174
		FW	5403	2	0	0	164	5638	2	0	0	172	5638	2	0	0	172	5579	2	0	0	170	5873	2	0	0	179
		32LD	530 mA (50.7W)	T1	7378	3	0	3	146	7698	3	0	3	152	7698	3	0	3	152	7618	3	0	3	150	8019	3	0
T2	7402			2	0	2	146	7724	2	0	2	152	7724	2	0	2	152	7643	2	0	2	151	8046	2	0	2	159
T3R	7310			2	0	2	144	7628	2	0	2	150	7628	2	0	2	150	7548	2	0	2	149	7946	2	0	2	157
T3	7411			1	0	2	146	7733	1	0	2	153	7733	1	0	2	153	7653	1	0	2	151	8056	1	0	2	159
T3W	7567			1	0	2	149	7896	1	0	2	156	7896	1	0	2	156	7813	1	0	2	154	8225	1	0	2	162
T3LG	7624			2	0	2	150	7955	2	0	2	157	7955	2	0	2	157	7873	2	0	2	155	8287	2	0	2	163
T4	7401			2	0	2	146	7722	2	0	2	152	7722	2	0	2	152	7642	2	0	2	151	8044	2	0	2	159
T4A	7835			2	0	1	155	8175	2	0	1	161	8175	2	0	1	161	8090	2	0	1	160	8516	2	0	1	168
T4FT	7088			1	0	2	140	7396	1	0	2	146	7396	1	0	2	146	7319	1	0	2	144	7704	1	0	2	152
T4LG	7609			2	0	2	150	7940	2	0	2	157	7940	2	0	2	157	7857	2	0	2	155	8271	2	0	2	163
T4T	7208			2	0	1	142	7522	2	0	1	148	7522	2	0	1	148	7444	2	0	1	147	7835	2	0	1	155
T5	7761			3	0	1	153	8098	3	0	1	160	8098	3	0	1	160	8014	3	0	1	158	8436	3	0	1	166
T5L	7198			3	0	2	142	7511	3	0	2	148	7511	3	0	2	148	7433	3	0	2	147	7824	3	0	2	154
T5LG	7653			3	0	1	151	7986	3	0	1	158	7986	3	0	1	158	7902	3	0	1	156	8318	3	0	1	164
T5W	7568			3	0	2	149	7897	3	0	2	156	7897	3	0	2	156	7815	3	0	2	154	8226	3	0	2	162
T5WW	7293			3	0	3	144	7610	3	0	3	150	7610	3	0	3	150	7531	3	0	3	149	7927	3	0	3	156
FN	7737			3	0	1	153	8074	4	0	1	159	8074	4	0	1	159	7990	3	0	1	158	8410	4	0	1	166
FM	7770			3	0	1	153	8108	4	0	1	160	8108	4	0	1	160	8024	3	0	1	158	8446	4	0	1	167
FW	8002			3	0	1	158	8349	3	0	1	165	8349	3	0	1	165	8263	3	0	1	163	8697	3	0	1	172
32LD	700 mA (67.9W)			T1	9565	3	0	3	141	9981	3	0	3	147	9981	3	0	3	147	9877	3	0	3	145	10396	3	0
		T2	9596	2	0	3	141	10014	2	0	3	147	10014	2	0	3	147	9909	2	0	3	146	10431	2	0	3	154
		T3R	9477	2	0	2	139	9889	2	0	2	146	9889	2	0	2	146	9786	2	0	2	144	10301	2	0	2	152
		T3	9608	2	0	2	141	10026	2	0	2	148	10026	2	0	2	148	9921	2	0	2	146	10444	2	0	2	154
		T3W	9810	2	0	2	144	10236	2	0	2	151	10236	2	0	2	151	10130	2	0	2	149	10663	2	0	2	157
		T3LG	9884	2	0	2	145	10314	2	0	2	152	10314	2	0	2	152	10206	2	0	2	150	10743	2	0	2	158
		T4	9594	2	0	2	141	10012	2	0	2	147	10012	2	0	2	147	9907	2	0	2	146	10429	2	0	2	153
		T4A	10157	2	0	1	149	10599	2	0	1	156	10599	2	0	1	156	10488	2	0	1	154	11040	2	0	1	162
		T4FT	9189	2	0	3	135	9588	2	0	3	141	9588	2	0	3	141	9488	2	0	3	140	9988	2	0	3	147
		T4LG	9865	2	0	2	145	10293	2	0	2	152	10293	2	0	2	152	10186	2	0	2	150	10722	2	0	2	158
		T4T	9345	2	0	1	138	9752	2	0	1	144	9752	2	0	1	144	9650	2	0	1	142	10158	2	0	1	150
		T5	10062	3	0	2	148	10499	3	0	2	155	10499	3	0	2	155	10390	3	0	2	153	10937	3	0	2	161
		T5L	9332	4	0	2	137	9738	4	0	2	143	9738	4	0	2	143	9636	4	0	2	142	10143	4	0	2	149
		T5LG	9922	3	0	1	146	10353	3	0	2	152	10353	3	0	2	152	10245	3	0	2	151	10784	3	0	2	159
		T5W	9812	3	0	2	144	10238	3	0	2	151	10238	3	0	2	151	10132	3	0	2	149	10665	4	0	2	157
		T5WW	9455	4	0	4	139	9866	4	0	4	145	9866	4	0	4	145	9763	4	0	4	144	10277	4	0	4	151
		FN	10031	4	0	1	148	10467	4	0	1	154	10467	4	0	1	154	10358	4	0	1</						

LED Specifications VOKEY ARCHLINE

		VKA-2 LED SPECIFICATIONS / Forward Optics																									
Led Count	Current & Watts	Distribution Type	70CRI																								
			27K					30K					35K					40K					50K				
			Lumens	B	U	G	LPW	Lumens	B	U	G	LPW	Lumens	B	U	G	LPW	Lumens	B	U	G	LPW	Lumens	B	U	G	LPW
64LD	350 mA (65.7W)	T1	9865	3	0	3	150	10294	3	0	3	157	10294	3	0	3	157	10187	3	0	3	155	10723	3	0	3	163
		T2	9898	2	0	3	151	10328	2	0	3	157	10328	2	0	3	157	10220	2	0	3	156	10758	2	0	3	164
		T3R	9774	2	0	2	149	10199	2	0	2	155	10199	2	0	2	155	10093	2	0	2	154	10624	2	0	2	162
		T3	9910	2	0	2	151	10340	2	0	2	157	10340	2	0	2	157	10233	2	0	2	156	10771	2	0	2	164
		T3W	10117	2	0	2	154	10557	2	0	2	161	10557	2	0	2	161	10447	2	0	2	159	10997	2	0	2	167
		T3LG	10194	2	0	2	155	10637	2	0	2	162	10637	2	0	2	162	10527	2	0	2	160	11081	2	0	2	169
		T4	9895	2	0	2	151	10326	2	0	2	157	10326	2	0	2	157	10218	2	0	2	156	10756	3	0	3	164
		T4A	10476	2	0	1	159	10931	2	0	1	166	10931	2	0	1	166	10817	2	0	1	165	11387	2	0	1	173
		T4FT	9477	2	0	3	144	9889	2	0	3	151	9889	2	0	3	151	9786	2	0	3	149	10301	2	0	3	157
		T4LG	10174	2	0	2	155	10616	2	0	2	162	10616	2	0	2	162	10506	2	0	2	160	11059	2	0	2	168
		T4T	9639	2	0	1	147	10058	2	0	1	153	10058	2	0	1	153	9953	2	0	1	151	10477	2	0	1	159
		T5	10378	3	0	2	158	10829	3	0	2	165	10829	3	0	2	165	10716	3	0	2	163	11280	3	0	2	172
		T5L	9625	4	0	2	146	10043	4	0	2	153	10043	4	0	2	153	9939	4	0	2	151	10462	4	0	3	159
		T5LG	10233	3	0	2	156	10678	3	0	2	163	10678	3	0	2	163	10567	3	0	2	161	11123	3	0	2	169
		T5W	10120	3	0	2	154	10560	4	0	2	161	10560	4	0	2	161	10450	4	0	2	159	11000	4	0	2	167
		T5WW	9752	4	0	4	148	10176	4	0	4	155	10176	4	0	4	155	10070	4	0	4	153	10600	4	0	4	161
		FN	10346	4	0	1	157	10796	4	0	1	164	10796	4	0	1	164	10683	4	0	1	163	11245	4	0	1	171
		FM	10390	4	0	1	158	10841	4	0	1	165	10841	4	0	1	165	10729	4	0	1	163	11293	4	0	1	172
		FW	10699	3	0	1	163	11164	3	0	1	170	11164	3	0	1	170	11048	3	0	1	168	11630	3	0	1	177
		64LD	530 mA (101.4W)	T1	14609	4	0	4	144	15244	4	0	4	150	15244	4	0	4	150	15086	4	0	4	149	15880	4	0
T2	14658			3	0	3	145	15295	3	0	3	151	15295	3	0	3	151	15136	3	0	3	149	15932	3	0	3	157
T3R	14475			3	0	3	143	15105	3	0	3	149	15105	3	0	3	149	14947	3	0	3	147	15734	3	0	3	155
T3	14675			2	0	2	145	15313	2	0	2	151	15313	2	0	2	151	15154	2	0	2	149	15952	2	0	2	157
T3W	14983			2	0	2	148	15635	2	0	2	154	15635	2	0	2	154	15472	2	0	2	153	16286	2	0	2	161
T3LG	15097			3	0	3	149	15753	3	0	3	155	15753	3	0	3	155	15589	3	0	3	154	16410	3	0	3	162
T4	14655			3	0	3	145	15292	3	0	3	151	15292	3	0	3	151	15132	3	0	3	149	15929	3	0	3	157
T4A	15514			3	0	2	153	16189	3	0	2	160	16189	3	0	2	160	16020	3	0	2	158	16863	3	0	2	166
T4FT	14035			2	0	3	138	14645	2	0	3	144	14645	2	0	3	144	14493	2	0	3	143	15255	2	0	3	150
T4LG	15067			3	0	2	149	15722	3	0	2	155	15722	3	0	2	155	15558	3	0	2	153	16377	3	0	2	162
T4T	14274			3	0	2	141	14895	3	0	2	147	14895	3	0	2	147	14740	3	0	2	145	15515	3	0	2	153
T5	15368			4	0	2	152	16037	4	0	2	158	16037	4	0	2	158	15870	4	0	2	157	16705	4	0	2	165
T5L	14254			4	0	3	141	14873	4	0	3	147	14873	4	0	3	147	14718	4	0	3	145	15493	4	0	3	153
T5LG	15154			4	0	2	149	15813	4	0	2	156	15813	4	0	2	156	15648	4	0	2	154	16474	4	0	2	162
T5W	14987			4	0	2	148	15638	4	0	2	154	15638	4	0	2	154	15475	4	0	2	153	16290	4	0	2	161
T5WW	14442			4	0	4	142	15070	4	0	4	149	15070	4	0	4	149	14913	4	0	4	147	15697	4	0	4	155
FN	15321			4	0	1	151	15988	4	0	1	158	15988	4	0	1	158	15821	4	0	1	156	16654	5	0	1	164
FM	15387			4	0	1	152	16056	4	0	1	158	16056	4	0	1	158	15888	4	0	1	157	16725	5	0	1	165
FW	15845			4	0	1	156	16534	4	0	1	163	16534	4	0	1	163	16361	4	0	1	161	17223	4	0	1	170
64LD	700 mA (135.9W)			T1	18940	4	0	4	139	19764	4	0	4	145	19764	4	0	4	145	19558	4	0	4	144	20587	4	0
		T2	19003	3	0	3	140	19829	3	0	3	146	19829	3	0	3	146	19622	3	0	3	144	20655	3	0	3	152
		T3R	18766	3	0	3	138	19582	3	0	3	144	19582	3	0	3	144	19378	3	0	3	143	20398	3	0	3	150
		T3	19026	3	0	3	140	19853	3	0	3	146	19853	3	0	3	146	19646	3	0	3	145	20680	3	0	3	152
		T3W	19425	3	0	3	143	20270	3	0	3	149	20270	3	0	3	149	20058	3	0	3	148	21114	3	0	3	155
		T3LG	19572	3	0	3	144	20423	3	0	3	150	20423	3	0	3	150	20210	3	0	3	149	21274	3	0	3	157
		T4	18999	3	0	3	140	19825	3	0	3	146	19825	3	0	3	146	19618	3	0	3	144	20651	3	0	3	152
		T4A	20113	3	0	2	148	20988	3	0	2	154	20988	3	0	2	154	20769	3	0	2	153	21862	3	0	2	161
		T4FT	18195	3	0	3	134	18987	3	0	3	140	18987	3	0	3	140	18789	3	0	3	138	19778	3	0	3	146
		T4LG	19534	3	0	2	144	20383	3	0	3	150	20383	3	0	3	150	20171	3	0	3	148	21232	3	0	3	156
		T4T	18506	3	0	2	136	19310	3	0	2	142	19310	3	0	2	142	19109	3	0	2	141	20115	3	0	2	148
		T5	19924	4	0	2	147	20791	4	0	2	153	20791	4	0	2	153	20574	4	0	2	151	21657	4	0	2	159
		T5L	18479	5	0	3	136	19282	5	0	3	142	19282	5	0	3	142	19082	5	0	3	140	20086	5	0	3	148
		T5LG	19647	4	0	2	145	20501	4	0	2	151	20501	4	0	2	151	20287	4	0	2	149	21355	4	0	2	157
		T5W	19429	4	0	2	143	20274	4	0	2	149	20274	4	0	2	149	20063	4	0	2	148	21119	5	0	3	155
		T5WW	18723	5	0	5	138	19537	5	0	5	144	19537	5	0	5	144	19333	5	0	5						

LED Specifications VOKEY ARCHLINE

		VKA-1 LED SPECIFICATIONS / Forward Optics																									
Led Count	Current & Watts	Distribution Type	70CRI																								
			27K					30K					35K					40K					50K				
			Lumens	B	U	G	LPW	Lumens	B	U	G	LPW	Lumens	B	U	G	LPW	Lumens	B	U	G	LPW	Lumens	B	U	G	LPW
16LD	350 mA (16.4W)	T1	2516	2	0	2	153	2625	2	0	2	160	2625	2	0	2	160	2598	2	0	2	158	2734	2	0	2	166
		T2	2524	1	0	1	154	2634	1	0	1	160	2634	1	0	1	160	2606	1	0	1	159	2743	1	0	1	167
		T3R	2492	1	0	1	152	2601	1	0	1	158	2601	1	0	1	158	2574	1	0	1	157	2709	1	0	1	165
		T3	2527	1	0	1	154	2637	1	0	1	160	2637	1	0	1	160	2609	1	0	1	159	2747	1	0	1	167
		T3W	2580	1	0	1	157	2692	1	0	1	164	2692	1	0	1	164	2664	1	0	1	162	2804	1	0	1	171
		T3LG	2600	1	0	1	158	2713	1	0	1	165	2713	1	0	1	165	2684	1	0	1	163	2826	1	0	1	172
		T4	2523	1	0	1	154	2633	1	0	1	160	2633	1	0	1	160	2606	1	0	1	159	2743	1	0	1	167
		T4A	2671	1	0	1	163	2787	1	0	1	170	2787	1	0	1	170	2758	1	0	1	168	2904	1	0	1	177
		T4FT	2417	1	0	1	147	2522	1	0	1	153	2522	1	0	1	153	2495	1	0	1	152	2627	1	0	1	160
		T4LG	2594	1	0	1	158	2707	1	0	1	165	2707	1	0	1	165	2679	1	0	1	163	2820	1	0	1	172
		T4T	2458	1	0	1	150	2565	1	0	1	156	2565	1	0	1	156	2538	1	0	1	154	2672	1	0	1	163
		T5	2646	1	0	1	161	2761	1	0	1	168	2761	1	0	1	168	2733	1	0	1	166	2876	2	0	1	175
		T5L	2454	2	0	1	149	2561	2	0	1	156	2561	2	0	1	156	2534	2	0	1	154	2668	2	0	1	162
		T5LG	2609	1	0	1	159	2723	1	0	1	166	2723	1	0	1	166	2694	1	0	1	164	2836	2	0	1	173
		T5W	2581	2	0	1	157	2693	2	0	1	164	2693	2	0	1	164	2665	2	0	1	162	2805	2	0	1	171
		T5WW	2487	2	0	2	151	2595	2	0	2	158	2595	2	0	2	158	2568	2	0	2	156	2703	2	0	2	164
		FN	2638	2	0	0	161	2753	2	0	0	168	2753	2	0	0	168	2724	2	0	0	166	2868	2	0	0	175
		FM	2649	2	0	0	161	2765	2	0	0	168	2765	2	0	0	168	2736	2	0	0	166	2880	2	0	0	175
		FW	2728	1	0	0	166	2847	1	0	0	173	2847	1	0	0	173	2817	1	0	0	171	2966	1	0	0	180
		16LD	530 mA (25.3W)	T1	3725	2	0	2	147	3887	2	0	2	153	3887	2	0	2	153	3847	2	0	2	152	4049	2	0
T2	3738			1	0	1	147	3900	1	0	2	154	3900	1	0	2	154	3860	1	0	2	152	4063	1	0	2	160
T3R	3691			1	0	1	146	3852	1	0	1	152	3852	1	0	1	152	3812	1	0	1	150	4012	1	0	1	158
T3	3742			1	0	1	148	3905	1	0	1	154	3905	1	0	1	154	3864	1	0	1	152	4068	1	0	1	160
T3W	3821			1	0	1	151	3987	1	0	1	157	3987	1	0	1	157	3945	1	0	1	156	4153	1	0	1	164
T3LG	3850			1	0	1	152	4017	1	0	1	159	4017	1	0	1	159	3975	1	0	1	157	4184	1	0	1	165
T4	3737			1	0	1	147	3899	1	0	1	154	3899	1	0	1	154	3859	1	0	1	152	4062	1	0	1	160
T4A	3956			1	0	1	156	4128	1	0	1	163	4128	1	0	1	163	4085	1	0	1	161	4300	1	0	1	170
T4FT	3579			1	0	1	141	3735	1	0	1	147	3735	1	0	1	147	3696	1	0	1	146	3890	1	0	1	153
T4LG	3842			1	0	1	152	4009	1	0	1	158	4009	1	0	1	158	3967	1	0	1	157	4176	1	0	1	165
T4T	3640			1	0	1	144	3798	1	0	1	150	3798	1	0	1	150	3759	1	0	1	148	3956	1	0	1	156
T5	3919			2	0	1	155	4089	2	0	1	161	4089	2	0	1	161	4047	2	0	1	160	4260	2	0	1	168
T5L	3635			3	0	1	143	3793	3	0	1	150	3793	3	0	1	150	3753	3	0	1	148	3951	3	0	1	156
T5LG	3864			2	0	1	152	4032	2	0	1	159	4032	2	0	1	159	3990	2	0	1	157	4200	2	0	1	166
T5W	3822			2	0	1	151	3988	2	0	1	157	3988	2	0	1	157	3946	2	0	1	156	4154	2	0	1	164
T5WW	3683			2	0	2	145	3843	3	0	3	152	3843	3	0	3	152	3803	3	0	3	150	4003	3	0	3	158
FN	3907			3	0	1	154	4077	3	0	1	161	4077	3	0	1	161	4034	3	0	1	159	4247	3	0	1	168
FM	3924			3	0	1	155	4094	3	0	1	162	4094	3	0	1	162	4052	3	0	1	160	4265	3	0	1	168
FW	4040			2	0	0	159	4216	2	0	0	166	4216	2	0	0	166	4172	2	0	0	165	4392	2	0	0	173
16LD	700 mA (34W)			T1	4830	3	0	3	142	5040	3	0	3	148	5040	3	0	3	148	4987	3	0	3	147	5250	3	0
		T2	4846	1	0	2	143	5056	1	0	2	149	5056	1	0	2	149	5004	1	0	2	147	5267	1	0	2	155
		T3R	4785	1	0	1	141	4993	1	0	1	147	4993	1	0	1	147	4941	1	0	1	145	5202	1	0	1	153
		T3	4852	1	0	1	143	5063	1	0	1	149	5063	1	0	1	149	5010	1	0	1	147	5273	1	0	1	155
		T3W	4953	1	0	1	146	5169	1	0	1	152	5169	1	0	1	152	5115	1	0	1	151	5384	1	0	1	158
		T3LG	4991	1	0	1	147	5208	1	0	1	153	5208	1	0	1	153	5154	1	0	1	152	5425	1	0	1	160
		T4	4845	1	0	1	143	5055	1	0	1	149	5055	1	0	1	149	5003	1	0	1	147	5266	1	0	1	155
		T4A	5129	1	0	1	151	5352	1	0	1	158	5352	1	0	1	158	5296	1	0	1	156	5575	1	0	1	164
		T4FT	4640	1	0	2	137	4842	1	0	2	143	4842	1	0	2	143	4791	1	0	2	141	5043	1	0	2	148
		T4LG	4981	1	0	1	147	5198	1	0	1	153	5198	1	0	1	153	5144	1	0	1	151	5414	1	0	1	159
		T4T	4719	1	0	1	139	4924	1	0	1	145	4924	1	0	1	145	4873	1	0	1	143	5129	1	0	1	151
		T5	5081	2	0	1	150	5302	2	0	1	156	5302	2	0	1	156	5246	2	0	1	154	5522	2	0	1	163
		T5L	4712	3	0	2	139	4917	3	0	2	145	4917	3	0	2	145	4866	3	0	2	143	5122	3	0	2	151
		T5LG	5010	2	0	1	147	5228	2	0	1	154	5228	2	0	1	154	5173	2	0	1	152	5446	2	0	1	160
		T5W	4955	3	0	1	146	5170	3	0	1	152	5170	3	0	1	152	5116	3	0	1	151	5385	3	0	1	159
		T5WW	4774	3	0	3	141	4982	3	0	3	147	4982	3	0	3	147	4930	3	0	3	145	5189	3	0	3	153
		FN	5065	3	0	1	149	5285	3	0	1	156	5285	3	0	1	156	5230	3	0	1	154	5506	3	0	1	162

LED Specifications VOKEY ARCHLINE

		VKA-3 LED SPECIFICATIONS / Forward Optics																									
Led Count	Current & Watts	Distribution Type	70CRI																								
			27K					30K					35K					40K					50K				
			Lumens	B	U	G	LPW	Lumens	B	U	G	LPW	Lumens	B	U	G	LPW	Lumens	B	U	G	LPW	Lumens	B	U	G	LPW
96LD	350 mA (98.6W)	T1	14501	4	0	4	147	15132	4	0	4	153	15132	4	0	4	153	14974	4	0	4	152	15762	4	0	4	160
		T2	14549	3	0	3	148	15182	3	0	3	154	15182	3	0	3	154	15024	3	0	3	152	15815	3	0	3	160
		T3R	14368	3	0	3	146	14993	3	0	3	152	14993	3	0	3	152	14837	3	0	3	150	15618	3	0	3	158
		T3	14567	2	0	2	148	15200	2	0	2	154	15200	2	0	2	154	15042	2	0	2	153	15834	2	0	2	161
		T3W	14873	2	0	2	151	15519	2	0	2	157	15519	2	0	2	157	15358	2	0	2	156	16166	2	0	2	164
		T3LG	14985	3	0	3	152	15637	3	0	3	159	15637	3	0	3	159	15474	3	0	3	157	16288	3	0	3	165
		T4	14546	3	0	3	148	15179	3	0	3	154	15179	3	0	3	154	15021	3	0	3	152	15811	3	0	3	160
		T4A	15400	3	0	2	156	16069	3	0	2	163	16069	3	0	2	163	15902	3	0	2	161	16739	3	0	2	170
		T4FT	13931	2	0	3	141	14537	2	0	3	147	14537	2	0	3	147	14386	2	0	3	146	15143	2	0	3	154
		T4LG	14956	3	0	2	152	15606	3	0	2	158	15606	3	0	2	158	15444	3	0	2	157	16256	3	0	2	165
		T4T	14169	3	0	2	144	14785	3	0	2	150	14785	3	0	2	150	14631	3	0	2	148	15401	3	0	2	156
		T5	15255	4	0	2	155	15918	4	0	2	161	15918	4	0	2	161	15752	4	0	2	160	16581	4	0	2	168
		T5L	14148	4	0	3	143	14764	4	0	3	150	14764	4	0	3	150	14610	4	0	3	148	15379	4	0	3	156
		T5LG	15042	4	0	2	153	15696	4	0	2	159	15696	4	0	2	159	15533	4	0	2	158	16350	4	0	2	166
		T5W	14876	4	0	2	151	15523	4	0	2	157	15523	4	0	2	157	15361	4	0	2	156	16170	4	0	2	164
		T5WW	14335	4	0	4	145	14958	4	0	4	152	14958	4	0	4	152	14802	4	0	4	150	15582	4	0	4	158
		FN	15208	4	0	1	154	15870	4	0	1	161	15870	4	0	1	161	15704	4	0	1	159	16531	5	0	1	168
		FM	15273	4	0	1	155	15937	4	0	1	162	15937	4	0	1	162	15771	4	0	1	160	16601	5	0	1	168
		FW	15728	4	0	1	160	16412	4	0	1	166	16412	4	0	1	166	16241	4	0	1	165	17095	4	0	1	173
		96LD	530 mA (152.1W)	T1	21476	4	0	4	141	22409	4	0	4	147	22409	4	0	4	147	22176	4	0	4	146	23343	4	0
T2	21547			3	0	4	142	22483	3	0	4	148	22483	3	0	4	148	22249	3	0	4	146	23420	3	0	4	154
T3R	21279			3	0	3	140	22204	3	0	3	146	22204	3	0	3	146	21973	3	0	3	144	23129	3	0	3	152
T3	21573			3	0	3	142	22511	3	0	3	148	22511	3	0	3	148	22276	3	0	3	146	23449	3	0	3	154
T3W	22025			3	0	3	145	22983	3	0	3	151	22983	3	0	3	151	22744	3	0	3	150	23941	3	0	3	157
T3LG	22192			3	0	3	146	23157	3	0	3	152	23157	3	0	3	152	22916	3	0	3	151	24122	3	0	3	159
T4	21542			3	0	3	142	22479	3	0	3	148	22479	3	0	3	148	22245	3	0	3	146	23415	3	0	3	154
T4A	22806			3	0	2	150	23797	3	0	3	156	23797	3	0	3	156	23549	3	0	3	155	24789	3	0	3	163
T4FT	20631			3	0	4	136	21528	3	0	4	142	21528	3	0	4	142	21304	3	0	4	140	22425	3	0	4	147
T4LG	22149			3	0	3	146	23112	3	0	3	152	23112	3	0	3	152	22871	3	0	3	150	24075	3	0	3	158
T4T	20983			3	0	2	138	21895	3	0	2	144	21895	3	0	2	144	21667	3	0	2	142	22808	3	0	2	150
T5	22592			4	0	2	149	23574	4	0	2	155	23574	4	0	2	155	23328	4	0	2	153	24556	4	0	2	161
T5L	20953			5	0	3	138	21864	5	0	3	144	21864	5	0	3	144	21636	5	0	3	142	22775	5	0	3	150
T5LG	22277			4	0	2	146	23245	4	0	2	153	23245	4	0	2	153	23003	4	0	2	151	24214	4	0	2	159
T5W	22030			5	0	3	145	22988	5	0	3	151	22988	5	0	3	151	22749	5	0	3	150	23946	5	0	3	157
T5WW	21229			5	0	5	140	22152	5	0	5	146	22152	5	0	5	146	21921	5	0	5	144	23075	5	0	5	152
FN	22522			5	0	1	148	23502	5	0	1	155	23502	5	0	1	155	23257	5	0	1	153	24481	5	0	1	161
FM	22618			5	0	1	149	23602	5	0	1	155	23602	5	0	1	155	23356	5	0	1	154	24585	5	0	1	162
FW	23292			4	0	1	153	24304	4	0	1	160	24304	4	0	1	160	24051	4	0	1	158	25317	4	0	1	166
96LD	700 mA (203.8W)			T1	27842	5	0	5	137	29052	5	0	5	143	29052	5	0	5	143	28750	5	0	5	141	30263	5	0
		T2	27934	3	0	4	137	29149	3	0	5	143	29149	3	0	5	143	28845	3	0	5	142	30363	3	0	5	149
		T3R	27587	3	0	4	135	28786	4	0	4	141	28786	4	0	4	141	28486	4	0	4	140	29985	4	0	4	147
		T3	27968	3	0	4	137	29184	3	0	4	143	29184	3	0	4	143	28880	3	0	4	142	30400	3	0	4	149
		T3W	28555	3	0	4	140	29796	3	0	4	146	29796	3	0	4	146	29486	3	0	4	145	31038	3	0	4	152
		T3LG	28771	3	0	3	141	30022	4	0	3	147	30022	4	0	3	147	29709	4	0	3	146	31273	4	0	4	153
		T4	27928	4	0	4	137	29143	4	0	4	143	29143	4	0	4	143	28839	4	0	4	141	30357	4	0	4	149
		T4A	29566	3	0	3	145	30852	3	0	3	151	30852	3	0	3	151	30530	3	0	3	150	32137	3	0	3	158
		T4FT	26747	3	0	4	131	27910	3	0	4	137	27910	3	0	4	137	27620	3	0	4	135	29073	3	0	4	143
		T4LG	28715	3	0	3	141	29963	3	0	4	147	29963	3	0	4	147	29651	3	0	3	145	31211	4	0	4	153
		T4T	27203	3	0	2	133	28386	3	0	2	139	28386	3	0	2	139	28091	3	0	2	138	29569	3	0	2	145
		T5	29289	5	0	3	144	30562	5	0	3	150	30562	5	0	3	150	30244	5	0	3	148	31836	5	0	3	156
		T5L	27164	5	0	4	133	28345	5	0	4	139	28345	5	0	4	139	28050	5	0	4	138	29526	5	0	4	145
		T5LG	28880	5	0	3	142	30136	5	0	3	148	30136	5	0	3	148	29822	5	0	3	146	31392	5	0	3	154
		T5W	28561	5	0	3	140	29803	5	0	3	146	29803	5	0	3	146	29493	5	0	3	145	31045	5	0	3	152
		T5WW	27523	5	0	5	135	28719	5	0	5	141	28719	5	0	5	141	28420	5								